

ALPINE

SERVICE MANUAL

FM/MW/LW/RDS CD Receiver

COMPACT
disc
DIGITAL AUDIO

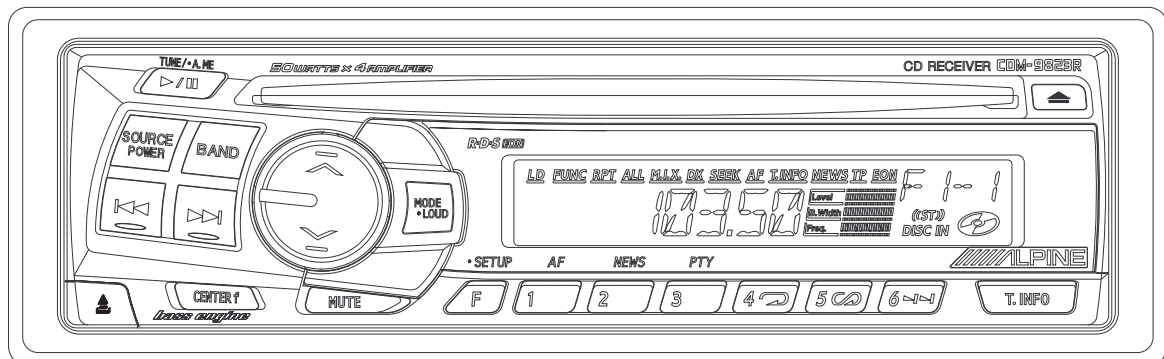

(CDM-9823R)

11/03-A
68E36143S01



CDM-9823R/CDM-9823RR CDE-9822RB/CDE-9821R CDE-9821RM

<Cautions for Safe Repair Work>



The following cautions will prevent accidents in the workplace and will ensure safe products.

*The symbols indicate caution is needed to prevent injuries and damage to property.



The symbols and their meanings follow.

 Warning	If you ignore this symbol and handle the product incorrectly or unsafely, serious injury or death may result.
 Caution	If you ignore this symbol and handle the product incorrectly or unsafely, injury or only material damage may result.



*The following symbols indicate two levels of cautions.



 When you see this symbol, you have to be very careful.	
 When you see this symbol, you have to follow the instructions there.	



Warning

 Do not look squarely into the laser light coming from the pickup. You may lose your sight.	 Fuse Caution Always use a designated fuse. Use of an incorrect fuse may result in a fire.
--	--

Caution

 Do not allow wiring to be caught in the screw/chassis. If wiring is caught in the screw/chassis, it may cause a short circuit, resulting in a fire.	 Battery Caution Use the designated battery. Confirm the correct polarity and seat of the battery. An incorrect battery or an improperly connected or seated battery may result in a fire.
---	---

 High Temperature Caution Touching the heat sink may cause severe burns.	 Designated Parts Caution Look up the part list and ensure that only designated parts are used to prevent problems or accidents.
---	---

 Reverse Power Supply Connections or Misconnections Caution Reverse power supply connections or misconnections may cause ignition problems and smoke may result.	 Wiring Caution Ensure that the wiring is correct when rewiring to prevent problems with ignition/breakdown.
---	---

 Soldering Caution Hot solder from solder splash may cause severe burns.	 Wear Gloves Wear gloves to prevent electrical shocks or injury from the end face of the metal.
---	--

**CDM-9823R/CDM-9823RR/CDE-9822RB/
CDE-9821R/CDE-9821RM**

Packing Assembly Parts List

Symbol No.	Part No.	Description
101-1	03S60820Y16	SCR,MCH 5X8 ZN A
101-2	36A02449K01	CAP,RUBBER(A)
101-3	01T04296K01	ISO/JASO ANT ADAPTER
101-4	03A60836Y01	SCR,CUS 5X7 ZN A
102	15D00529K02	CASE,INNER
103	15D01798K03	CARRYING,CASE

Symbol No.	Part No.	Description
104	68P02294K90	OM AOEJ AODN
#1 105	01T75373Y01	ASSY,ISO CONN 9823R
\$1 105	01T75373Y01	ASSY,ISO CONN 9823R
%1 105	01T75373Y02	ASSY,ISO CONN 9825R
&1 105	01T75373Y01	ASSY,ISO CONN 9823R
#2 105	01T75373Y01	ASSY,ISO CONN 9823R

NOTE : #1 : For CDM-9823R Model Only, \$1 : For CDM-9823RR Model Only, %1 : For CDE-9822RB Model Only, &1 : For CDE-9821R Model Only, #1 : For CDE-9821RM Model Only, Others : Common.

Packing Method View

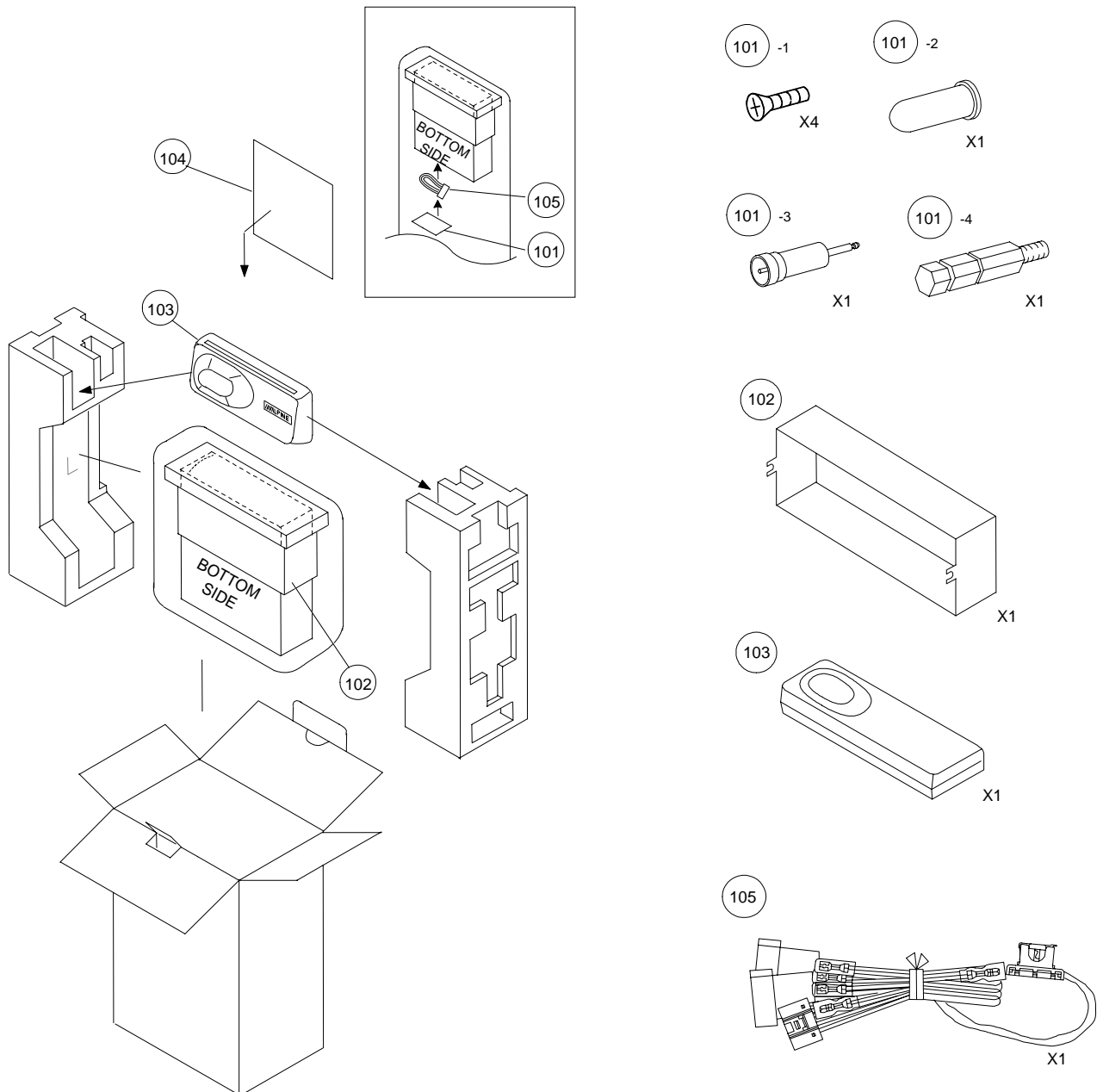

Specifications

<FM RADIO>

Intermediate Frequency	10.7±0.2MHz
Frequency Range	87.5 to 108.0MHz
Usable Sensitivity (Mono, 30dB S/N, at 98.1MHz)	20.2dBf
-3dB Limiting Sensitivity (at 98.1MHz)	19.2dBf
Residual Noise (Ref. 400Hz (WID), at 98.1MHz)	25±10dB
S/N Ratio (at 98.1MHz)	Stereo : 50dB Mono : 55dB
Image Rejection (at 106.1MHz)	40dB
IF Rejection (at 90.1MHz)	60dB
Distortion (Input 60dBu, at 98.1MHz)	1.5%
Frequency Response (Ref. 400Hz, at 98.1MHz)	100Hz : 0±3dB 10kHz : -12±3dB
Stereo Separation (1kHz, at 98.1MHz)	20dB
PS Sensitivity (at 98.1MHz)	36.2dBf
TP OFF Alarm (at 98.1MHz)	70±10Sec.

<MW RADIO>

Intermediate Frequency	1st. IF : 10.71MHz 2nd. IF : 450kHz
Frequency Range	531 to 1,602kHz
Usable Sensitivity (20dB S/N, at 999kHz)	36dB
S/N Ratio (at 999kHz)	42dB
Image Rejection (at 603kHz)	40dB
IF Rejection (at 603kHz)	40dB
Distortion (at 999kHz)	1.5%
Frequency Response (Ref. 400Hz, at 999kHz)	100Hz : -3+3,-4dB 4kHz : -12+4, -8dB

<LW RADIO>

Intermediate Frequency	1st. IF : 10.71MHz 2nd. IF : 450kHz
Frequency Range	153 to 281kHz
Usable Sensitivity (20dB S/N, at 216kHz)	43dB
S/N Ratio (at 216kHz)	40dB
Image Rejection (at 270kHz)	40dB
IF Rejection (at 162kHz)	45dB
Distortion (at 216kHz)	1.5%
Frequency Response (Ref. 400Hz, at 216kHz)	100Hz : -3+3,-4dB 4kHz : -12+4, -8dB

<Pickup>

Wave Length	795nm
Laser Power	CLASS I

**CDM-9823R/CDM-9823RR/CDE-9822RB/
CDE-9821R/CDE-9821RM**

<CD SECTION>

System	Optical (Compact Disc System)
Channel Balance (1kHz, TCD-782)	0±3dB
Distortion (1kHz, TCD-782)	0.1%
Frequency Response (Ref. 1kHz, TCD-782)	17Hz : 0±3dB 127Hz : 0±2dB 10.007kHz : 0±2dB 19.997kHz : 0±4dB
S/N Ratio (TCD-782)	85dB
Separation (1kHz, TCD-782)	55dB
De-Emphasis (Ref. 1kHz, TCD-782)	4kHz : -20±3dB 16kHz : -20±3dB

<GENERAL>

Power Supply	DC14.4V
Power Output (Ref. CD Mode/SP-OUT, T.H.D. 10%)/Impedance	16W/ch/4ohm
Pre Output (Ref. CD (TCD-782 (0dB/1kHz)), T.H.D. 1%, /Impedance	2V±2.5dBV/ch/10kohm SUB-W OFF Mode, Rear PRE-OUT Mode)
Dimensions (W x H x D)	Chassis : 178 x 50 x 160mm Nose : 188 x 58 x 27mm
Weight	1.5kg

NOTE : Due to Continuing product improvement, specifications and designs are subject to change without notice.

Extension Cable

* When repairing or measuring the voltage of this unit, connect with the Extension Cable as shown in below.

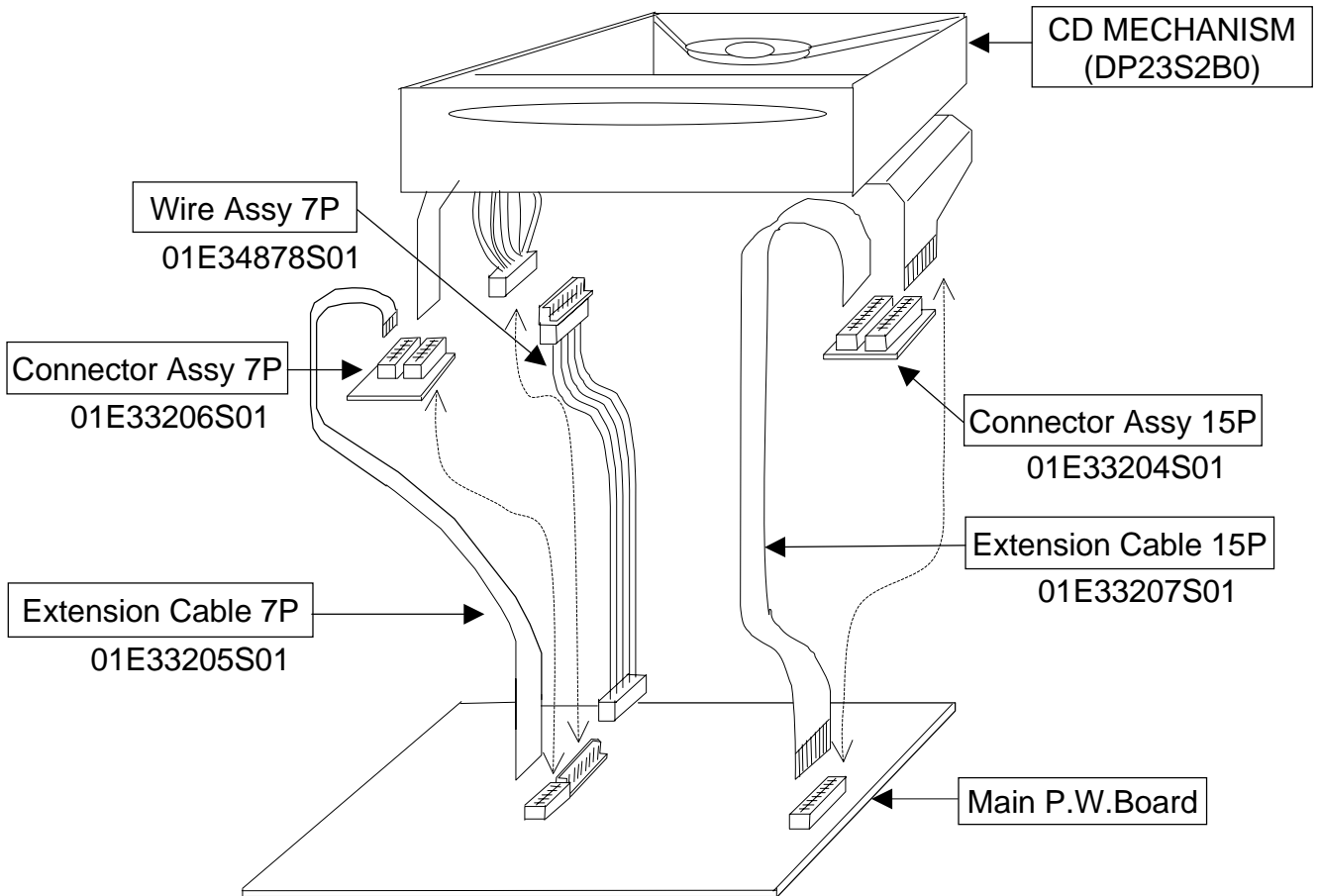

Block Diagram

CDM-9823R/CDM-9823RR/CDE-9822RB/
CDE-9821R/CDE-9821RM

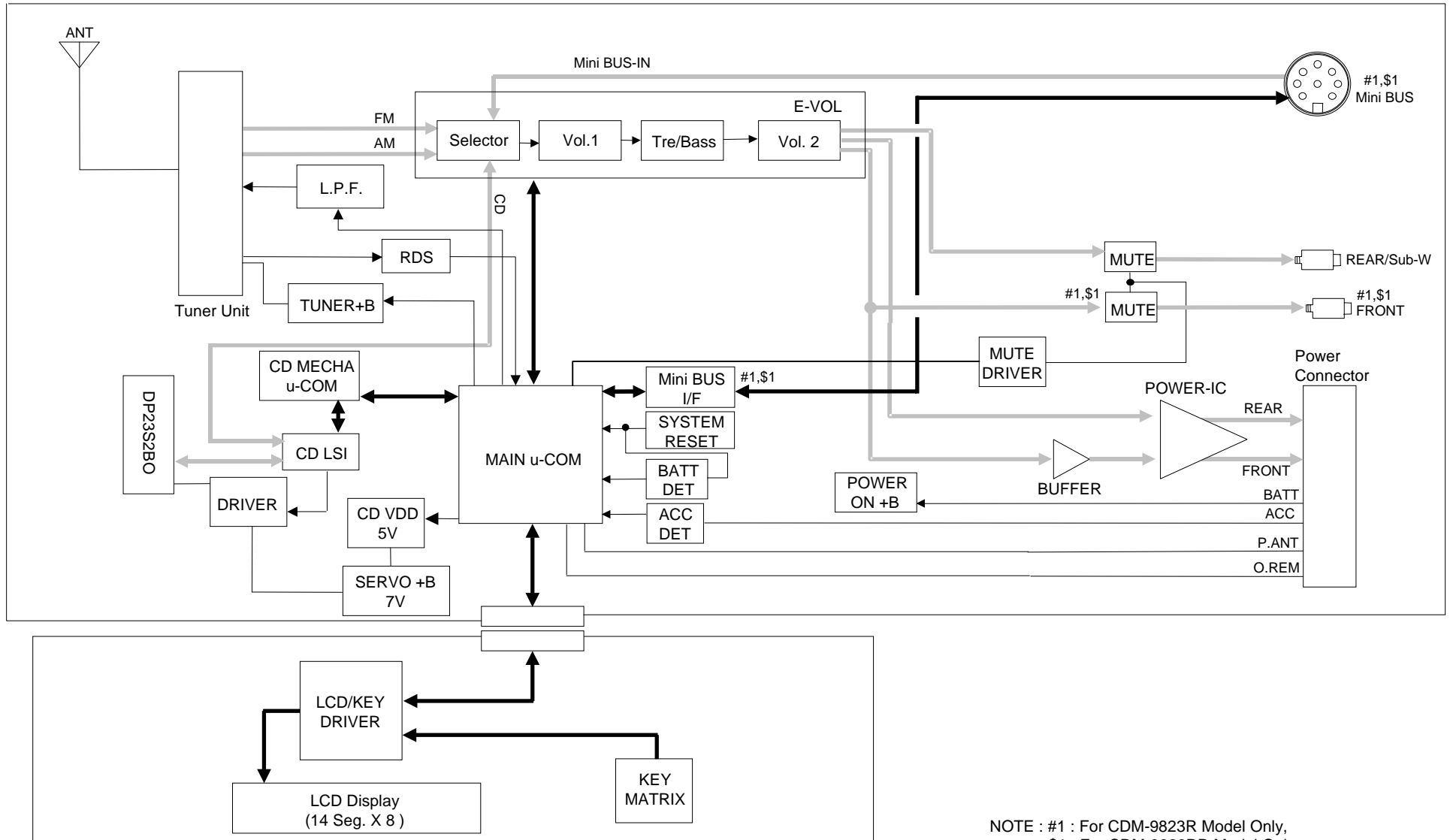

NOTE : #1 : For CDM-9823R Model Only,
\$1 : For CDM-9823RR Model Only,
Others : Common.

Schematic Diagram (1/6)

CDM-9823R/CDM-9823RR/CDE-9822RB/
CDE-9821R/CDE-9821RM

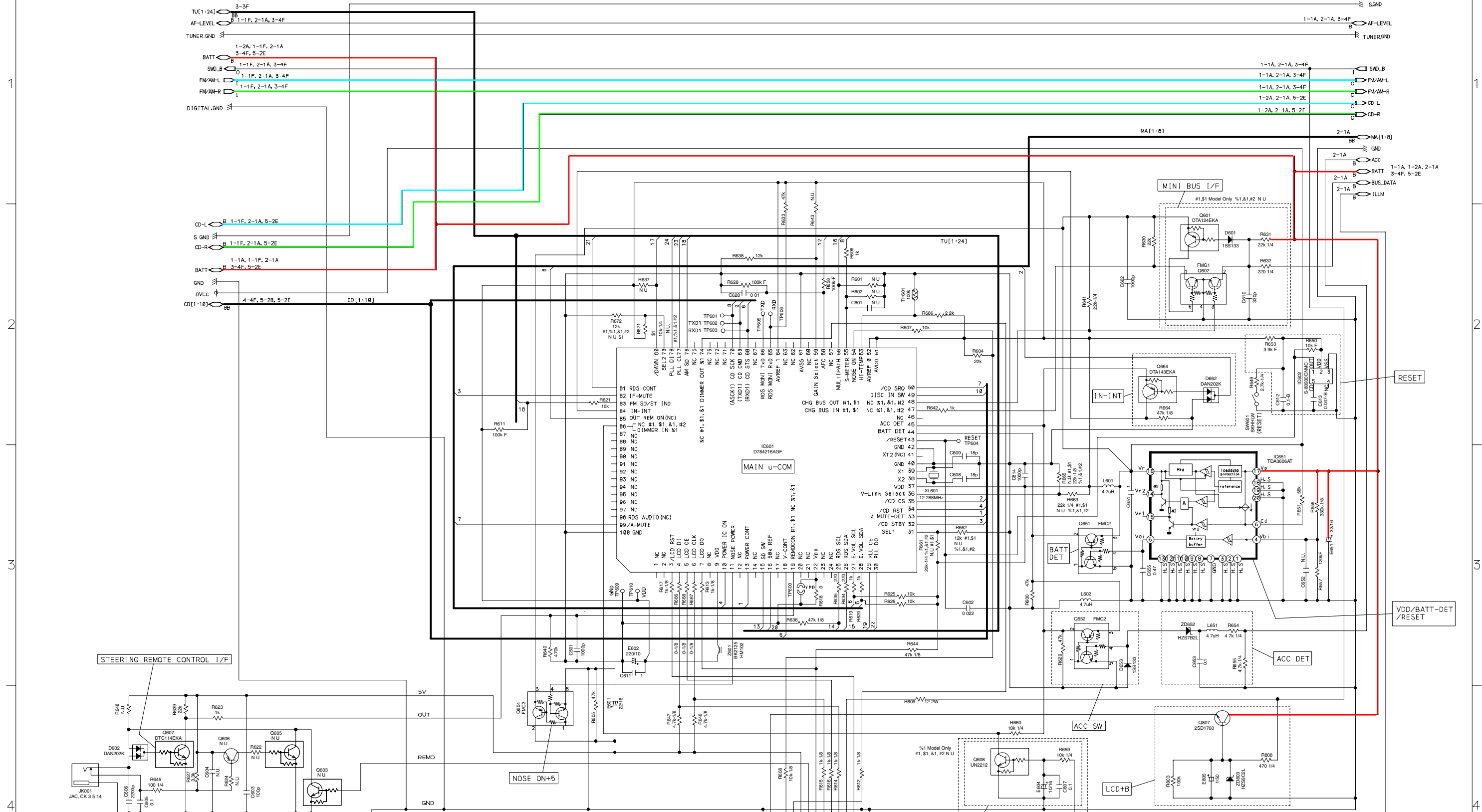

MAIN P.W. Board (1/5)
NOTE: N. U. is Not Used Parts.

NOTE: #1: For CDM-9823R Model Only,
\$1: For CDM-9823RR Model Only,
%1: For CDE-9822RB Model Only,
&1: For CDE-9821R Model Only,
#2: For CDE-9821RM Model Only,
Others: Common.

Schematic Diagram (2/6)

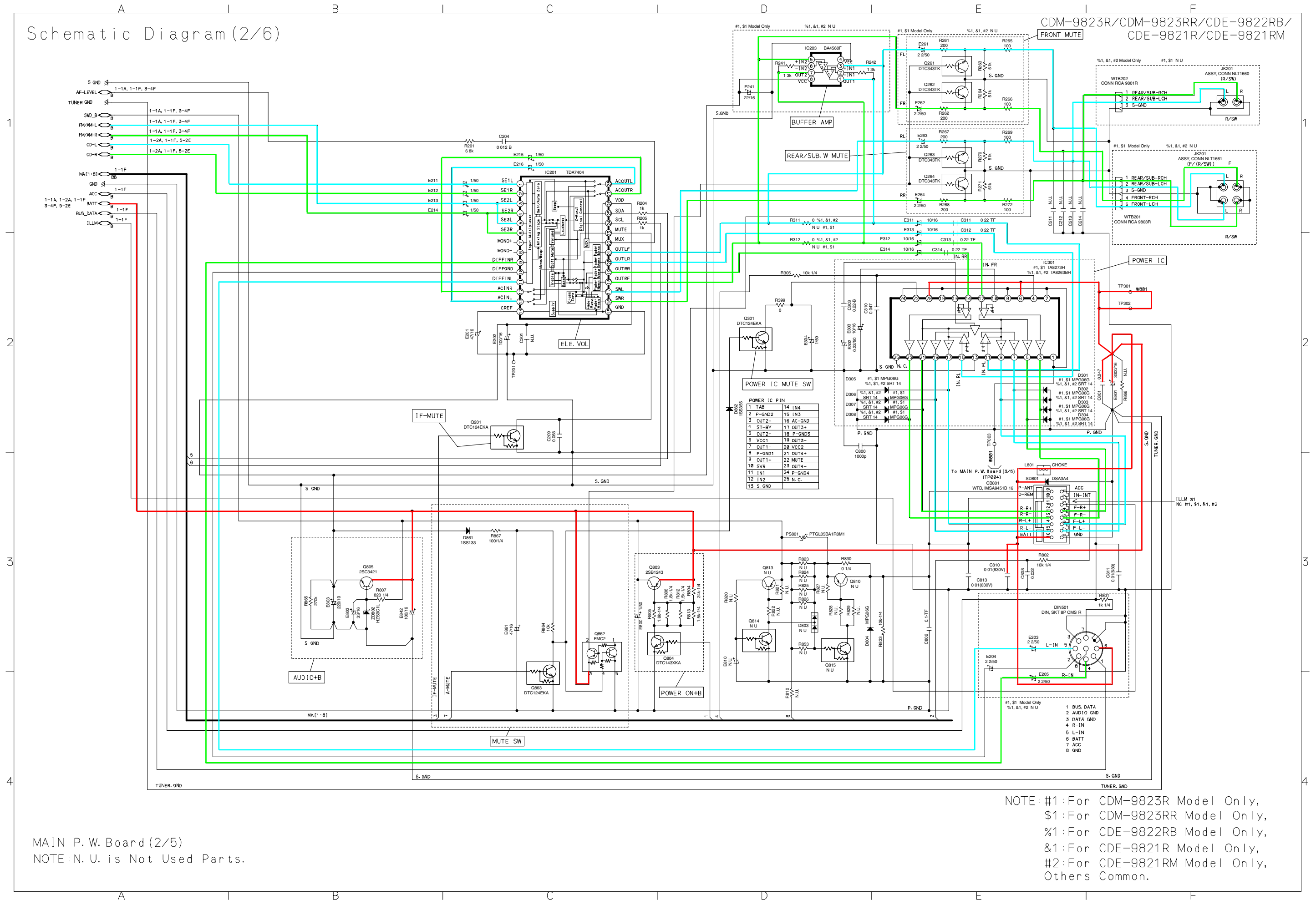

MAIN P.W. Board (2/5)
 NOTE: N. U. is Not Used Parts.

NOTE: #1: For CDM-9823R Model Only,
 \$1: For CDM-9823RR Model Only,
 %1: For CDE-9822RB Model Only,
 &1: For CDE-9821R Model Only,
 #2: For CDE-9821RM Model Only,
 Others: Common.

Schematic Diagram (3/6)

CDM-9823R/CDM-9823RR/CDE-9822RB/
CDE-9821R/CDE-9821RM

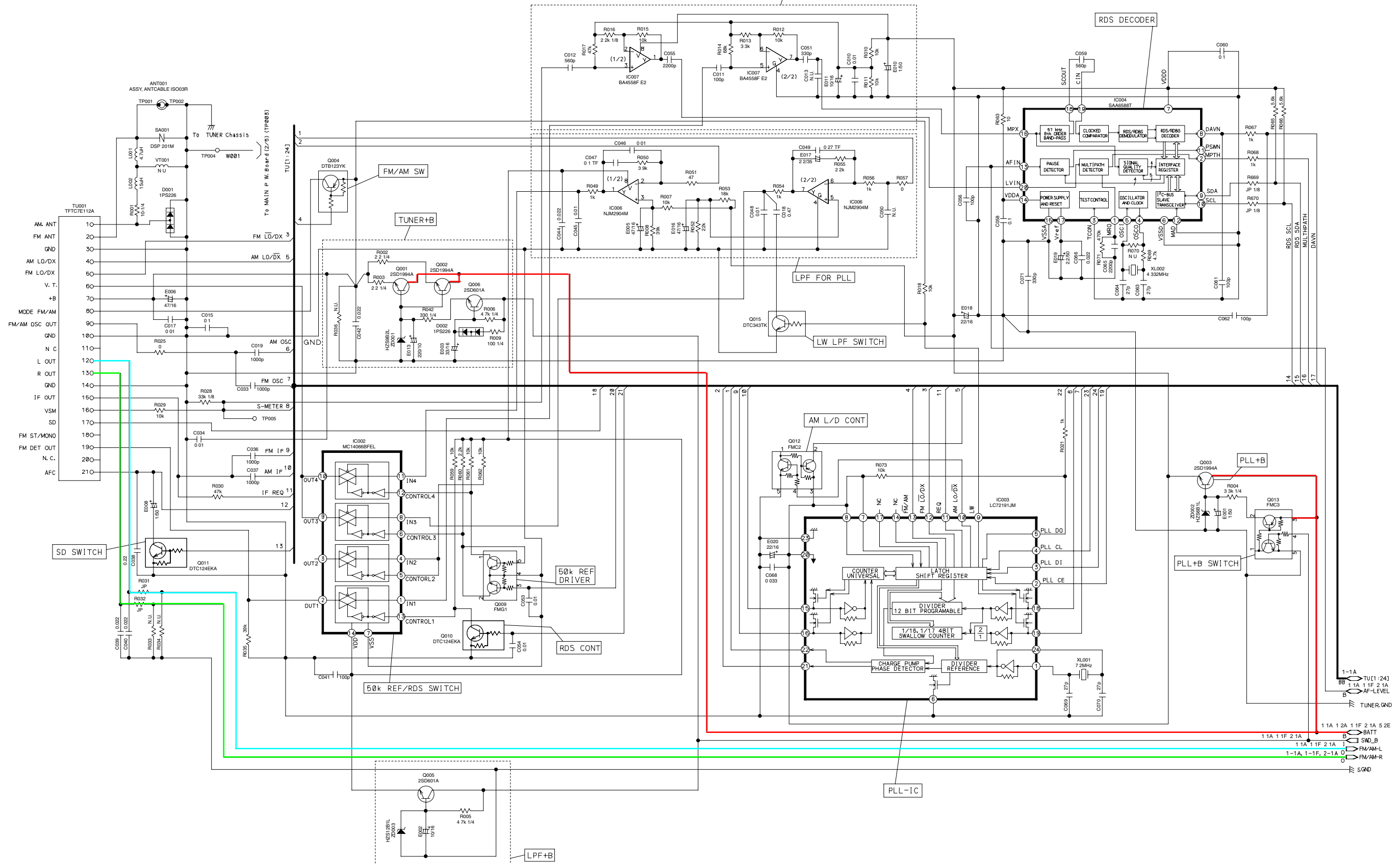

MAIN P.W. Board (3/5)
NOTE: N.U. is Not Used Parts.

Schematic Diagram (4/6)

CDM-9823R/CDM-9823RR/CDE-9822RB/
CDE-9821R/CDE-9821RM

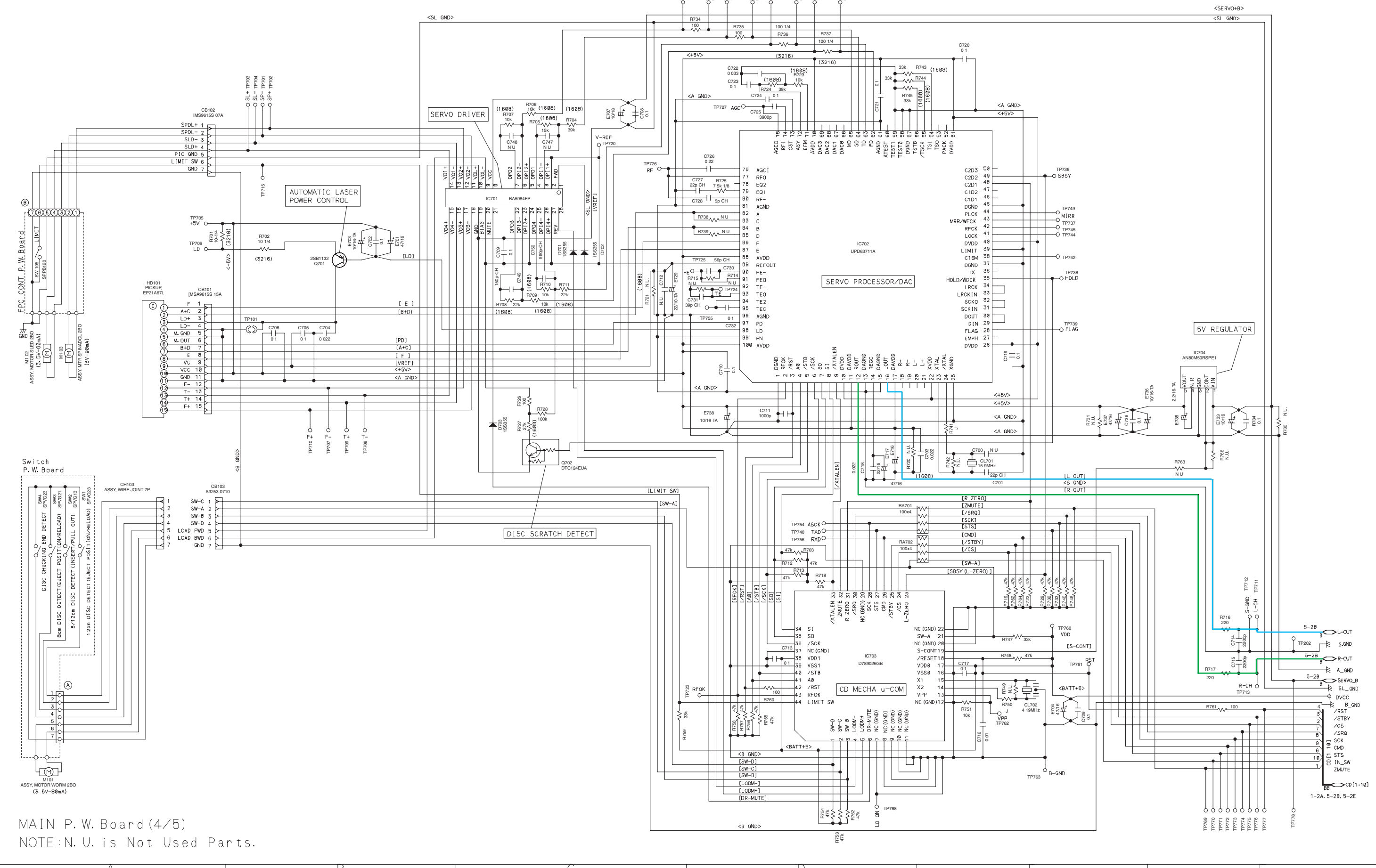

MAIN P.W. Board (4/5)
NOTE: N. U. is Not Used Parts.

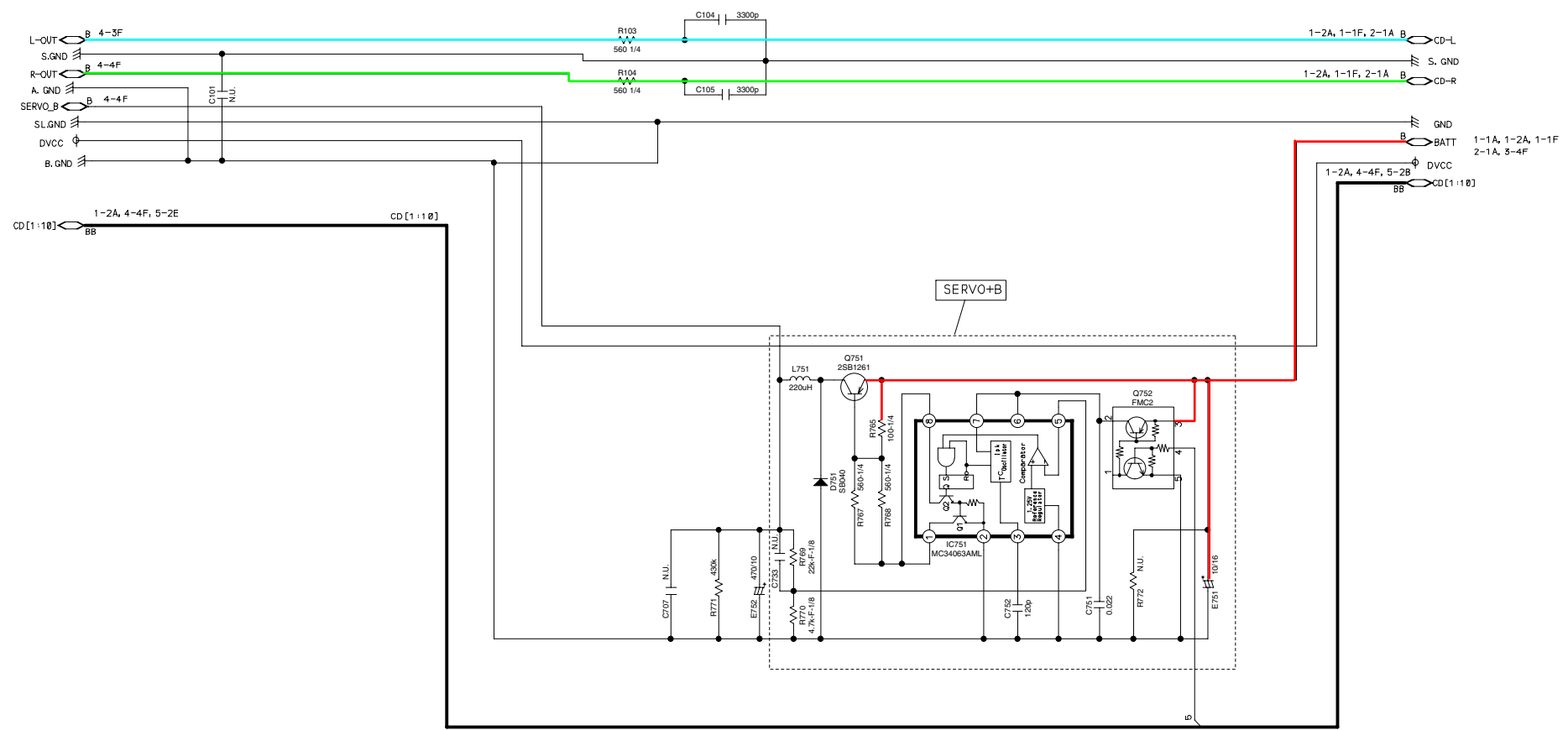

MAIN P. W. Board (5/5)
NOTE: N. U. is Not Used Parts.

Schematic Diagram (6/6)

CDM-9823R/CDM-9823RR/CDE-9822RB/
CDE-9821R/CDE-9821RM

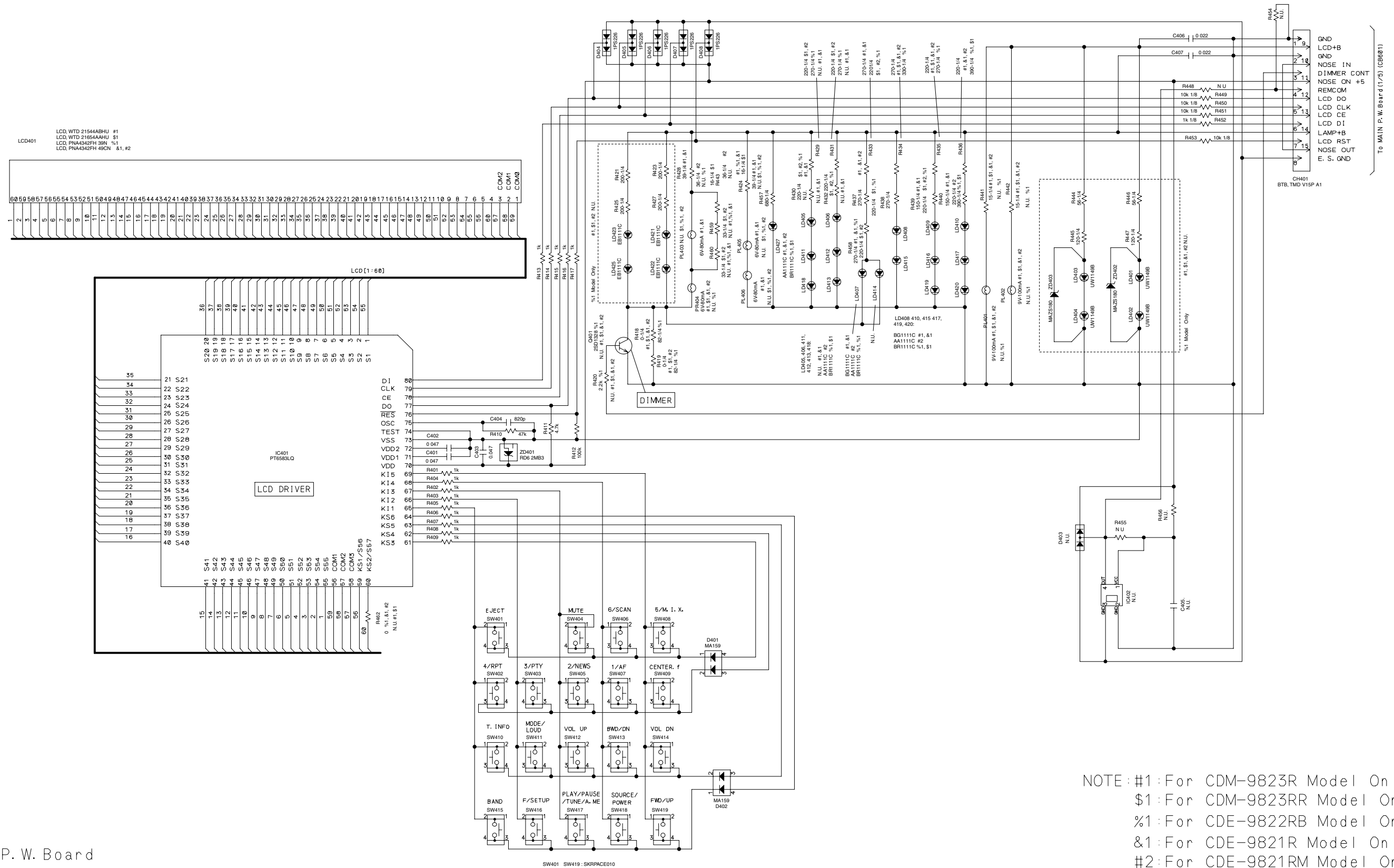

FRONT P. W. Board
NOTE: N. U. is Not Used Parts.

NOTE: #1: For CDM-9823R Model Only,
\$1: For CDM-9823RR Model Only,
%1: For CDE-9822RB Model Only,
&1: For CDE-9821R Model Only,
#2: For CDE-9821RM Model Only,
Others: Common.

**CDM-9823R/CDM-9823RR/CDE-9822RB/
CDE-9821R/CDE-9821RM**

Terminal Voltage of IC/TR

IC002					
1	4		9	1.32 to 6.8	FM
2	4			1.78 to 3.3	MW
3	NC			1.36 to 1.5	LW
4	12		10	1.32 to 6.8	FM
5	12			1.78 to 3.3	MW
	0	FM		1.36 to 1.5	LW
6	11	MW	11	1.32 to 6.8	FM
	11	LW		0 to 11	MW
7	0			11	LW
8	0.35	FM	12	12	
	1.78 to 3.3	MW	13	12	
	1.36 to 1.5	LW	14	12	

IC004			
1	0.2	11	NC
2	0.2	12	0
3	0	13	2.6
4	2.6	14	5.2
5	2.2	15	0
6	0	16	2.6
7	5.2	17	2.6
8	5.2	18	2.6
9	5.2	19	2.5
10	4.6	20	2.6

IC003					
1	2.4		13	0 / 8.4	FM/MW,LW
2	0		14	NC	
3	0		15	0	
4	0		16	0	
5	0		17	NC	
6	0		18	0	
7	0		19	2.7	
8	5.2		20	5.2	
9	0/5.2	FM,MW/LW	21	4.2	
10	0		22	2.9	
11	0		23	0	
12	8.2 / 0	FM/MW,LW	24	2.7	

IC006		
1	1.32 to 6.8	FM
	0 to 11	MW
	11	LW
2	4.2	
3	4.2	
4	0	
5	2.8	
6	2.9	
7	0.35	FM
	1.78 to 3.3	MW
	1.36 to 1.5	LW
8	12	

IC007	
1	2.6
2	2.6
3	2.6
4	0
5	2.6
6	2.6
7	2.6
8	5.2

IC201							
1	4.3	8	4.4	15	0	22	4.4
2	4.3	9	4.3	16	4.4	23	5
3	4.3	10	4.3	17	4.4	24	0.5
4	4.3	11	4.3	18	4.4	25	0.5
5	4.3	12	4.3	19	4.4	26	8.7
6	4.3	13	4.3	20	4.4	27	4.4
7	4.3	14	4.4	21	4.4	28	4.4

#1,\$1 IC203	
1	4.4
2	4.4
3	4.4
4	0
5	4.4
6	4.4
7	4.4
8	8.8

IC301									
1	0	6	14.2	11	1.4	16	1.4	21	7.5
2	0	7	7.6	12	1.4	17	7.6	22	4.1
3	7.5	8	0	13	0	18	0	23	7.5
4	5	9	7.6	14	1.4	19	7.6	24	0
5	7.5	10	8.5	15	1.4	20	14.2	25	NC

NOTE : #1 : For CDM-9823R Model Only, \$1 : For CDM-9823RR Model Only,
Others : Common.

**CDM-9823R/CDM-9823RR/CDE-9822RB/
CDE-9821R/CDE-9821RM**

IC401										
1	2.4	17	2.4	33	2.4	49	2.4		65	0
2	2.4	18	2.4	34	2.4	50	2.4		66	0
3	2.4	19	2.4	35	2.4	51	2.4		67	0
4	2.4	20	2.4	36	2.4	52	2.4		68	0
5	2.5	21	2.4	37	2.4	53	2.4		69	0
6	2.4	22	2.4	38	2.4	54	2.4		70	4.9
7	2.5	23	2.4	39	2.4	55	2.4		71	3.2
8	2.4	24	2.4	40	2.4	56	2.4		72	1.6
9	2.5	25	2.4	41	2.4	57	2.4		73	0
10	2.4	26	2.4	42	2.4	58	2.4		74	0
11	2.4	27	2.4	43	2.4	59	2.4		75	3.8
12	2.4	28	2.4	44	2.4	60	2.4	%1,&1,#2	76	4.4
13	2.4	29	2.4	45	2.4	61	4.9		77	4.9
14	2.4	30	2.4	46	2.4	62	4.9		78	0.7
15	2.4	31	2.4	47	2.4	63	4.9		79	0.2
16	2.4	32	2.4	48	2.4	64	4.9		80	1.3

IC601										
1	NC			35	4.95 / 0	CD/RADIO		69	0	
2	NC			36	0 / 5	%1,&1,#2/#1,\$1		70	4.95 / 0	CD/RADIO
3	4.96			37	4.96			71	NC	
4	1.3			38	2.7			72	NC	
5	0.7			39	2.5			73	NC	
6	0.2			40	0			74	4.95	
7	4.8			41	NC			75	NC	
8	NC			42	0			76	4.9	
9	4.96			43	4.95			77	0	
10	4.96			44	4.96			78	0	
11	4.92			45	4.95			79	4.95 / 0	\$1/#1,%1,&1,#2
12	NC			46	NC			80	5.2	
13	4.9			47	4.97			81	0	
14	NC			48	0			82	0.2	
15	4.94			49	4.96			83	4.9 / 0	MONO/ST
16	4.94			50	0			84	0	
17	NC			51	4.96			85	NC	
18	4.94			52	4.96			86	4.95	
19	4.7			53	4.8			87	NC	
20	NC			54	2.5			88	NC	
21	NC			55	4.6 / 3.6	FM/MW,LW		89	NC	
22	0			56	0.3			90	NC	
23	NC			57	NC			91	NC	
24	NC			58	3			92	NC	
25	4.7			59	0			93	NC	
26	4.9			60	NC			94	NC	
27	0			61	0			95	NC	
28	0			62	NC			96	NC	
29	0			63	NC			97	NC	
30	0			64	4.96			98	NC	
31	4.95 / 0	%1,&1,#2/#1,\$1		65	4.94			99	4.94	
32	4.95 / 0	CD/RADIO		66	4.96			100	0	
33	0			67	NC					
34	4.96 / 0	CD/RADIO		68	4.96 / 0	CD/RADIO				

NOTE : #1 : For CDM-9823R Model Only, \$1 : For CDM-9823RR Model Only,
%1 : For CDE-9822RB Model Only, &1 : For CDE-9821R Model Only,
#2 : For CDE-9821RM Model Only, Others : common.

**CDM-9823R/CDM-9823RR/CDE-9822RB/
CDE-9821R/CDE-9821RM**

IC602	
1	4.95
2	4.95
3	0
4	NC
5	0

IC651							
1	0	6	2.7	11	0	16	5
2	0	7	0	12	0	17	14.2
3	0	8	0	13	0	18	0
4	3.6	9	0	14	NC	19	0
5	4.9	10	0	15	NC	20	0

IC701											
1	0	CD mode	8	7.1	CD mode	15	3.4	CD mode	22	2.5	CD mode
2	2.5		9	0		16	3.4		23	2.5	
3	2.5		10	0		17	3.4		24	2.5	
4	2.5		11	3.8		18	3.3		25	2.5	
5	2.5		12	2.8		19	0		26	2.5	
6	2.5		13	3.34		20	2.5		27	2.5	
7	2.34		14	3.3		21	4.6		28	0	

IC702											
1	0	CD mode	26	5	CD mode	51	5	CD mode	76	2.5	CD mode
2	5		27	NC		52	NC		77	2.1	
3	5		28	0		53	NC		78	NC	
4	3.2		29	2.5		54	0		79	2.2	
5	4.9		30	2.5		55	0		80	2.3	
6	3.6		31	2.5		56	0		81	0	
7	0.9		32	2.5		57	0		82	2.6	
8	2.2		33	2.5		58	0		83	2.5	
9	0		34	2.5		59	0		84	2.6	
10	5		35	0		60	NC		85	2.5	
11	5		36	NC		61	25		86	2.9	
12	2.5		37	0		62	2.5		87	2.9	
13	0		38	2.9		63	2.5		88	5	
14	2.6		39	0		64	2.6		89	2.5	
15	0		40	5		65	NC		90	2.5	
16	2.4		41	5		66	NC		91	2.5	
17	5		42	2.5		67	NC		92	2.5	
18	0		43	0		68	NC		93	2.5	
19	5		44	2.6		69	NC		94	2.6	
20	5		45	0		70	5		95	2.5	
21	0		46	NC		71	2.5		96	0	
22	5		47	NC		72	2.5		97	0.2	
23	1.93		48	0		73	2.9		98	3.8	
24	2.3		49	0		74	2.5		99	0	
25	0		50	NC		75	2.5		100	5	

**CDM-9823R/CDM-9823RR/CDE-9822RB/
CDE-9821R/CDE-9821RM**

IC703					
1	0	CD mode	23	0	CD mode
2	0		24	1.2	
3	0		25	5	
4	0		26	0	
5	0		27	5	
6	5		28	5	
7	0		29	0	
8	0		30	0	
9	0		31	0	
10	0		32	0	
11	0		33	0	
12	0		34	0	
13	0		35	0	
14	3.2		36	0	
15	2.6		37	0	
16	0		38	0	
17	5		39	0	
18	5		40	0	
19	5		41	0	
20	0		42	0	
21	0		43	0	
22	0		44	0	

IC704		
1	7.1	CD mode
2	7.1	
3	0	
4	1.26	
5	5	
6	14.2	
7	14.2	
8	9.1	

IC751		
1	9.1	CD mode
2	0	
3	0.8	
4	0	
5	1.26	

Pin No.	1	2	3	4	5	NOTE
Q009	12	0	0.94	0	11	
Q012	NC	0 / 1	5.2	0	0	FM/MW,LW
Q013	NC	14.2	14.2	14.2	0	
#1,\$1 Q602	4.97	14.2	0	0	0	
Q604	NC	4.93	5	4.92	0	
Q651	NC	4.96	4.96	4.96	0	
Q652	NC	4.95	4.96	4.95	0	
Q752	NC	14.2 / 0	14.2	4.9/0	0	CD / RADIO
Q862	NC	0	14.3	0	0	

NOTE : #1 : For CDM-9823R Model Only, \$1 : For CDM-9823RR Model Only,
Others : Common.

**CDM-9823R/CDM-9823RR/CDE-9822RB/
CDE-9821R/CDE-9821RM**

Pin No.	B	E	C	
Q001	9.1	8.5	14.3	
Q002	9.1	8.5	14.3	
Q003	5.8	5.2	14.3	
Q004	0 / 8.4	8.5	8.4 / 0.3	FM/MW,LW
Q005	12.7	12	14.2	
Q006	14	13.3	14.2	
Q010	0	0	12	
Q011	4.9	0	0	
Q015	3.1/0.24	0	0	LW/FM,MW
Q201	0	0	5	
#1,\$1 Q261	0	0	0	
#1,\$1 Q262	0	0	0	
Q263	0	0	0	
Q264	0	0	0	
Q301	0	0	4.1	
%1 Q401	0.6	0	0.1	
#1,\$1 Q601	5	5	0	
Q607	0	0	4.7	
%1 Q608	0	0	4.95	
Q664	4.95	4.95	0	
Q701	3.8	4.5	2.1	CD
Q702	0	0	2.5	CD
Q751	14.4	14.4	7.2 / 0	CD / RADIO
Q803	13.5	14.3	14.2	
Q804	4.9	0	0	
Q805	9.3	8.6	14.3	
Q807	9.5	8.9	14.4	
Q863	4.94	0	0	

NOTE : #1 : For CDM-9823R Model Only, \$1 : For CDM-9823RR Model Only,
%1 : For CDE-9822RB Model Only, Others : Common.

[Measuring Conditions]

- 1.Power Supply Voltage : DC14.4V
 - 2.Measuring Meter : Digital Multi Meter
 - 3.Measuring Point Reference : Between GND
 - 4.Measuring Condition : FM : 98.1MHz
AM : 999KHz
CD : at playing Disc
- * All the data was measured in FM mode expect noted.

**CDM-9823R/CDM-9823RR/CDE-9822RB/
CDE-9821R/CDE-9821RM**

Description of IC Terminal

D784216AGF : IC601

No.	Symbol	I/O	Terminal Description
1	NC	-	No connect terminal.
2			
3	/ LCD RST	O	RESET signal output terminal to LCD Driver (LC75883).
4	LCD DI	O	Serial Data signal output terminal to LCD Driver (LC75883).
5	LCD CE	O	Chip Enable signal output terminal to LCD Driver (LC75883).
6	LCD CLK	O	Serial Clock signal output terminal to LCD Driver (LC75883).
7	LCD DO	I	Serial Data signal input terminal from LCD Driver (LC75883).
8	NC	-	No connect terminal.
9	VDD	-	Power supply terminal.
10	POWER IC ON	O	STBY CONT signal output terminal to Power IC.
11	NOSE POWER	O	Power supply control signal output terminal of LCD Driver and Remote Control.
12	NC	-	No connect terminal.
13	POWER CONT	O	Power supply control signal output terminal of Audio and Key lighting.
14	NC	-	No connect terminal.
15	SD SW	O	Time Constant switching terminal of High Speed PLL active by AF Check etc.
16	50k REF	O	LPF switching output terminal at RDS active.
17	NC	-	No connect terminal.
18	V-CONT	O	Power supply control signal output terminal of Servo/Mechanism.
19	REMOCON	I	Remote Control Data input terminal.
20	NC		No connect terminal.
21			
22	Vpp	-	Flash Memory writing terminal.
23	NC	-	No connect terminal.
24			
25	RDS SCL	O	RDS Clock output terminal from RDS Decoder (SAA6588T).
26	RDS SDA	I/O	RDS Data input/output terminal to RDS Decoder (SAA6588T).
27	E.VOL SCL	O	Serial Clock signal output terminal to E.VOL (TDA7404).
28	E.VOL SDA	I/O	Serial Data signal input/output terminal to E.VOL (TDA7404).
29	PLL CE	O	Communication CONT signal output terminal to PLL (LC72191M).
30	PLL DO	I	Data input terminal from PLL (LC72191M).
31	SEL1	I	Model selection input terminal.
32	/CD STBY	O	Stand-by control signal output terminal of Mechanism u-COM.
33	0 MUTE-DET	I	0-bit MUTE signal input terminal.
34	/CD RST	O	RESET signal output terminal of Mechanism u-COM.
35	/CD CS	O	Communication control signal output terminal of Mechanism u-COM.
36	V-Link Select	I	V-Link set up input terminal.
37	VDD	-	Power supply terminal.
38	X2	-	Main System Clock OSC input terminal. (12.288MHz)
39	X1		
40	GND	-	GND connect terminal.
41	XT2(NC)	-	No connect terminal.
42	GND	-	GND connect terminal.
43	/RESET	I	System RESET signal input terminal.
44	BATT DET	I	BATT detect signal input terminal. (Compulsion Stand-by)

NOTE : #1 : For CDM-9823R Model Only, \$1 : For CDM-9823RR Model Only, %1 : For CDE-9822RB Model Only,
&1 : For CDE-9821R Model Only, #2 : For CDE-9821RM Model Only, Others : Common.

**CDM-9823R/CDM-9823RR/CDE-9822RB/
CDE-9821R/CDE-9821RM**

No.	Symbol	I/O	Terminal Description
45	ACC DET	I	ACC (IGNITION) detect signal input terminal.
46	NC	-	No connect terminal.
47	#1,\$1 CHG BUS IN	I	Signal input terminal from CD CHANGER BUS I/F.
	%1,&1,#2 NC	-	No connect terminal.
48	#1,\$1 CHG BUS OUT	O	Signal output terminal to CD CHANGER BUS I/F.
	%1,&1,#2 NC	-	No connect terminal.
49	DISC IN SW	I	DISC insert detect SW input terminal.
50	/CD SRQ	I	Communication request signal input terminal from Mechanism u-COM.
51	AVDD	-	Analog power supply terminal of A/D Converter.
52	AVREF 0	-	Standard voltage input terminal of A/D Converter.
53	HI-TEMP	I	Temperature sensor signal (Thermistor) input terminal for CD.
54	NOSE ON	I	FRONT Panel detect signal input terminal.
55	S-METER	I	Signal Meter input terminal.
56	MULTIPATH	I	Multipath rejection detect terminal of receiving station.
57	NC	-	No connect terminal.
58	AFC	I	AFC signal input terminal.
59	GAIN Select	I	Sub-W output GAIN set up input terminal.
60	NC	-	No connect terminal.
61	AVSS	-	GND terminal of A/D Converter.
62	NC	-	No connect terminal.
63			
64	AVREF 1	-	Standard voltage input terminal of A/D Converter.
65	RDS MONI RxD	I	Serial Data input terminal from RDS Monitor Soft (P/C).
66	RDS MONI TxD	O	Serial Data output terminal to RDS Monitor Soft (P/C).
67	NC	-	No connect terminal.
68	CD STS	I	Status signal input terminal from Mechanism u-COM.
	(RXD1)	-	(Flash-Pro II connect terminal by UART format.)
69	CD CMD	O	Command output terminal to Mechanism u-COM.
	(TXD1)	-	(Flash-Pro II connect terminal by UART format.)
70	CD SCK	O	Serial Clock output terminal to Mechanism u-COM.
	(ASCK1)	-	(Flash-Pro II connect terminal by UART format.)
71	NC	-	No connect terminal.
I			
73			
74	#1,\$1,&1,#2 NC	-	No connect terminal.
	%1 DIMMER OUT		
75	NC	-	No connect terminal.
76	AM SD	I	AM SD signal input terminal.
77	PLL CL	O	Sync. signal output terminal to PLL (LC72191M).
78	PLL DI	O	Data output terminal to PLL (LC72191M).
79	SEL2	I	Model selection input terminal.
80	/DAVN	I	Available input terminal of RDS Decoder (SAA6588T).
81	RDS CONT	O	MPX MUTE signal output terminal to RDS Decoder (SAA6588T) at FM adjoining rejection.
82	IF-MUTE	O	High Speed MUTE signal output terminal at AF SW.
83	FM SD/ST IND	I	ST signal input terminal at FM receiving. (L : at receiving ST) FM SD signal input terminal at FM tuning. (H : SD ON)
84	IN-INT	I	External AUDIO signal input terminal.

NOTE : #1 : For CDM-9823R Model Only, \$1 : For CDM-9823RR Model Only, %1 : For CDE-9822RB Model Only,
&1 : For CDE-9821R Model Only, #2 : For CDE-9821RM Model Only, Others : Common.

**CDM-9823R/CDM-9823RR/CDE-9822RB/
CDE-9821R/CDE-9821RM**

No.	Symbol	I/O	Terminal Description
85	OUT REM ON(NC)	-	No connect terminal.
86	#1,\$1,&1,#2 NC	-	No connect terminal.
	%1 DIMMER IN	I	Outernal DIMMER detect signal input terminal.
87	NC	-	No connect terminal.
I			
97			
98			
99	/A-MUTE	O	AUDIO MUTE signal output terminal. (L : MUTE ON)
100	GND	-	GND connect terminal.

NOTE : #1 : For CDM-9823R Model Only, \$1 : For CDM-9823RR Model Only, %1 : For CDE-9822RB Model Only,
&1 : For CDE-9821R Model Only, #2 : For CDE-9821RM Model Only, Others : Common.

D789026GB : IC703

No.	Symbol	I/O	Terminal Description
1	SW-D	I	SW-D input terminal for mechanism control.
2	SW-C	I	SW-C input terminal for mechanism control.
3	SW-B	I	SW-B input terminal for mechanism control.
4	LODM-	O	Loading Motor control output terminal.
5	LODM+		
6	DR MUTE	O	Driver IC Mute control output terminal.
7	NC(GND)	-	GND connect terminal.
I			
12			
13	VPP	-	Pull-down connect terminal.
14	X2	-	Crystal OSC connect terminal. (4.19MHz)
15	X1		
16	VSS0	-	GND connect terminal.
17	VDD0	-	VDD connect terminal.
18	/RESET	I	Host I/F RESET signal input terminal.
19	S-CONT	O	Servo power supply control output terminal.
20	NC(GND)	-	GND connect terminal.
21	SW-A	I	SW-A input terminal for mechanism control.
22	NC(GND)	-	GND connect terminal.
23	L-ZERO	I	DSP L-ch 0 data signal input terminal.
24	/CS	I	Host I/F communication start/end signal input terminal.
25	/STBY	I	Host I/F STBY signal input terminal.
26	CMD	I	Host I/F command input terminal.
27	STS	O	Host I/F status output terminal.
28	SCK	I	Clock input terminal for Host I/F communication.
29	NC(GND)	-	GND connect terminal.
30	/SRQ	O	Host I/F status request signal output terminal.
31	R-ZERO	I	DSP R-ch 0 data signal input terminal.
32	ZMUTE	O	Host I/F 0 data signal output terminal.
33	/XTALEN	O	DSP crystal OSC control output terminal.
34	SI	O	DSP serial data output terminal.

**CDM-9823R/CDM-9823RR/CDE-9822RB/
CDE-9821R/CDE-9821RM**

No.	Symbol	I/O	Terminal Description
35	SO	I	DSP serial data/status signal input terminal.
36	/SCK	O	Clock output terminal for DSP serial data.
37	NC(GND)	-	GND connect terminal.
38	VDD1	-	VDD connect terminal.
39	VSS1	-	GND connect terminal.
40	/STB	O	DSP data strobe signal output terminal.
41	AO	O	DSP command/parameter discrimination signal output terminal.
42	/RST	O	DSP RESET signal output terminal.
43	RFOK	I	DSP RFOK signal input terminal.
44	LIMIT SW	I	LIMIT-SW input terminal.

Exploded View (CD Deck Mechanism)

(DP23S2BO)

CDM-9823R/CDM-9823RR/CDE-9822RB/
CDE-9821R/CDE-9821RM

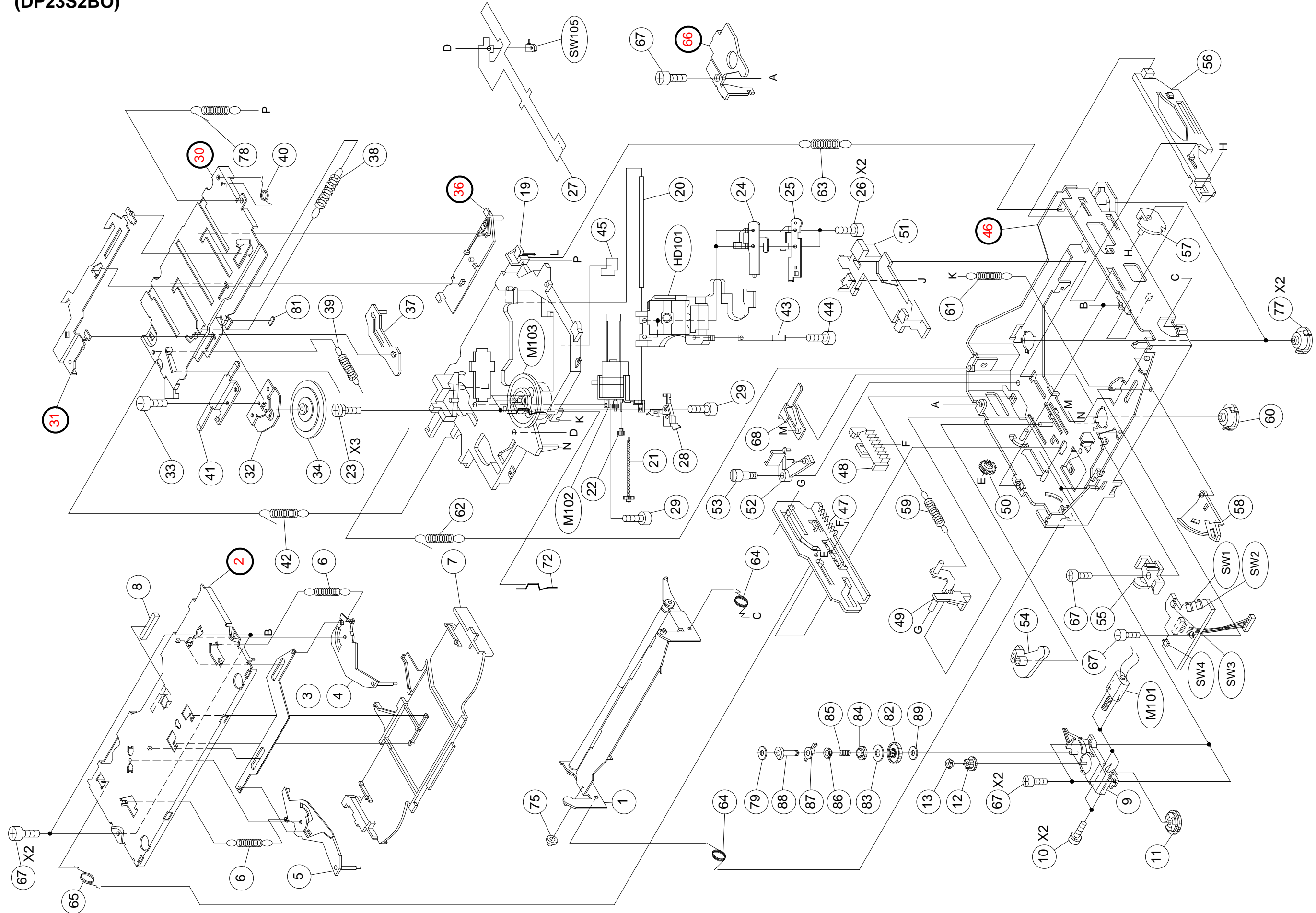

**CDM-9823R/CDM-9823RR/CDE-9822RB/
CDE-9821R/CDE-9823RM**

Electrical Parts List

Note : #1 : For CDM-9823R Model Only, \$1 : For CDM-9823RR Model Only,
%1 : For CDE-9822RB Model Only, &1 : For CDE-9821R Model Only,
#2 : For CDE-9821RM Model Only, Others : Common.

* Each parts on P.W.Board are described in order of the reference number.

=====MAIN P.W.Board

C010	08S45676W73	CAP,CER.103K-B1H -CP
C011	08S45677W36	CAP,CER.101J-CH1H-CP
C012	08S45677W54	CAP,CER 561J-CH1H-CP
C015	08S45676W85	CAP,CER 104K-B1C -CP
C017	08S45676W73	CAP,CER.103K-B1H -CP
C018	08S60102F44	CAP,CER 474K-B1E -CP
C019	08S45677W60	CAP,CER 102J-CH1H-CP
C033	08S45677W60	CAP,CER 102J-CH1H-CP
C034	08S45676W73	CAP,CER.103K-B1H -CP
C036	08S45677W60	CAP,CER 102J-CH1H-CP
C037	08S45677W60	CAP,CER 102J-CH1H-CP
C038	08S45676W93	CAP,CER 224K-B1A -CP
C039	08S45676W80	CAP,CER 223K-B1E -CP
C040	08S45676W80	CAP,CER 223K-B1E -CP
C041	08S45677W36	CAP,CER.101J-CH1H-CP
C042	08S45676W80	CAP,CER 223K-B1E -CP
C044	08S45676W80	CAP,CER 223K-B1E -CP
C045	08S45676W73	CAP,CER.103K-B1H -CP
C046	08S45676W73	CAP,CER.103K-B1H -CP
C047	08T35122W13	CAP,MMTS-104-J -R5
C048	08S45676W73	CAP,CER.103K-B1H -CP
C049	08T55390W34	CAP,TF 274J-1H -R5
C051	08S45677W48	CAP,CER.331J-CH1H-CP
C053	08S45676W73	CAP,CER.103K-B1H -CP
C054	08S45676W73	CAP,CER.103K-B1H -CP
C055	08S45676W65	CAP,CER.222K-B1H -CP
C056	08S45677W36	CAP,CER.101J-CH1H-CP
C058	08S45676W85	CAP,CER 104K-B1C -CP
C059	08S45677W54	CAP,CER 561J-CH1H-CP
C060	08S45676W85	CAP,CER 104K-B1C -CP
C061	08S45677W36	CAP,CER.101J-CH1H-CP
C062	08S45677W36	CAP,CER.101J-CH1H-CP
C063	08S45677W22	CAP,CER.27RJ-CH1H-CP
C064	08S45677W22	CAP,CER.27RJ-CH1H-CP
C065	08S45676W65	CAP,CER.222K-B1H -CP
C066	08S45676W80	CAP,CER 223K-B1E -CP
C068	08S45676W87	CAP,CER 333K-B1E -CP
C069	08S45677W22	CAP,CER.27RJ-CH1H-CP
C070	08S45677W22	CAP,CER.27RJ-CH1H-CP
C071	08S45677W48	CAP,CER.331J-CH1H-CP
C104	08S45676W67	CAP,CER.332K-B1H -CP
C105	08S45676W67	CAP,CER.332K-B1H -CP
C204	08S45676W74	CAP,CER 123K-B1H -CP
C209	08S45676W84	CAP,CER 683K-B1C -CP
C303	08S45676W93	CAP,CER 224K-B1A -CP
C310	08S45676W83	CAP,CER 473K-B1C -CP
C311	08T35122W17	CAP,MMTS-224-J -R5

**CDM-9823R/CDM-9823RR/CDE-9822RB/
CDE-9821R/CDE-9823RM**

	C312	08T35122W17	CAP,MMTS-224-J -R5
	C313	08T35122W17	CAP,MMTS-224-J -R5
	C314	08T35122W17	CAP,MMTS-224-J -R5
	C501	08S45677W60	CAP,CER 102J-CH1H-CP
	C602	08S65128F78	CAP,CER.223K-B1H -CP
	C603	08S45677W36	CAP,CER.101J-CH1H-CP
	C605	08S65128F88	CAP,CER 104K-B1H -CP
	C606	08S45676W65	CAP,CER.222K-B1H -CP
%1	C607	08S45676W85	CAP,CER 104K-B1C -CP
	C608	08S45677W18	CAP,CER.18RJ-CH1H-CP
	C609	08S45677W18	CAP,CER.18RJ-CH1H-CP
#1	C610	08S45677W48	CAP,CER.331J-CH1H-CP
\$1	C610	08S45677W48	CAP,CER.331J-CH1H-CP
	C611	08S60102F48	CAP,CER 105K-B1E -CP
	C612	08S35374W01	CAP,CER 104K-B1E-CP
	C613	08S65128F90	CAP,CER 473K-B1H -CP
	C628	08S45676W73	CAP,CER.103K-B1H -CP
	C651	08S60102F48	CAP,CER 105K-B1E -CP
	C653	08S45676W85	CAP,CER 104K-B1C -CP
	C655	08S60102F44	CAP,CER 474K-B1E -CP
	C662	08S45677W60	CAP,CER 102J-CH1H-CP
	C701	08S45677W20	CAP,CER.22RJ-CH1H-CP
	C702	08S45676W85	CAP,CER 104K-B1C -CP
	C703	08S45676W80	CAP,CER 223K-B1E -CP
	C704	08S45676W80	CAP,CER 223K-B1E -CP
	C705	08S45676W85	CAP,CER 104K-B1C -CP
	C706	08S45676W85	CAP,CER 104K-B1C -CP
	C708	08S45676W85	CAP,CER 104K-B1C -CP
	C709	08S45676W85	CAP,CER 104K-B1C -CP
	C710	08S45676W85	CAP,CER 104K-B1C -CP
	C711	08S45677W60	CAP,CER 102J-CH1H-CP
	C713	08S45676W85	CAP,CER 104K-B1C -CP
	C714	08S45676W65	CAP,CER.222K-B1H -CP
	C715	08S45676W65	CAP,CER.222K-B1H -CP
	C716	08S45676W73	CAP,CER.103K-B1H -CP
	C717	08S45676W85	CAP,CER 104K-B1C -CP
	C718	08S45676W80	CAP,CER 223K-B1E -CP
	C719	08S45676W85	CAP,CER 104K-B1C -CP
	C720	08S45676W85	CAP,CER 104K-B1C -CP
	C721	08S45676W85	CAP,CER 104K-B1C -CP
	C722	08S45676W87	CAP,CER 333K-B1E -CP
	C723	08S45676W85	CAP,CER 104K-B1C -CP
	C724	08S45676W85	CAP,CER 104K-B1C -CP
	C725	08S45676W68	CAP,CER.392K-B1H -CP
	C726	08S45676W93	CAP,CER 224K-B1A -CP
	C727	08S45677W20	CAP,CER.22RJ-CH1H-CP
	C728	08S45677W07	CAP,CER.5R0C-CH1H-CP
	C729	08S45676W85	CAP,CER 104K-B1C -CP
	C730	08S45677W30	CAP,CER.56RJ-CH1H-CP
	C731	08S45677W26	CAP,CER.39RJ-CH1H-CP
	C732	08S45676W85	CAP,CER 104K-B1C -CP
	C734	08S45676W85	CAP,CER 104K-B1C -CP
	C736	08S45676W85	CAP,CER 104K-B1C -CP
	C749	08S45677W40	CAP,CER.151J-CH1H-CP
	C750	08S45677W54	CAP,CER 561J-CH1H-CP
	C751	08S65128F78	CAP,CER.223K-B1H -CP
	C752	08S45677W38	CAP,CER 121J-CH1H-CP

**CDM-9823R/CDM-9823RR/CDE-9822RB/
CDE-9821R/CDE-9823RM**

	C800	08S45677W60	CAP,CER 102J-CH1H-CP
	C801	08S45676W89	CAP,CER 473K-B1E -CP
	C802	08T35122W13	CAP,MMTS-104-J -R5
	C808	08S45676W80	CAP,CER 223K-B1E -CP
	C810	08S45539Y04	CAP,CER 103KX7R2J-CP
	C811	08S45539Y04	CAP,CER 103KX7R2J-CP
	C813	08S45539Y04	CAP,CER 103KX7R2J-CP
	C814	08S45677W60	CAP,CER 102J-CH1H-CP
	CB101	09T55355Y15	FFC,IMSA9615S-15A-DB
	CB102	09T55355Y07	FFC,IMSA9615S-07A-DB
	CB103	09T25436Y07	WTB,53253-0710 -DB
	CL701	91T55147Y01	OSC,CER CSACV16M9-E1
	CL702	91T45281Y03	OSC,CER CSTCR4M19-E1
	D001	48T85357W01	DIO,1PS226 -CP
	D002	48T85357W01	DIO,1PS226 -CP
#1	D301	48T85270W01	DIO,MPG06G -A5
\$1	D301	48T85270W01	DIO,MPG06G -A5
%1	D301	48T02162K01	DIO,SHT SRT14 -A5
&1	D301	48T02162K01	DIO,SHT SRT14 -A5
#2	D301	48T02162K01	DIO,SHT SRT14 -A5
#1	D302	48T85270W01	DIO,MPG06G -A5
\$1	D302	48T85270W01	DIO,MPG06G -A5
%1	D302	48T02162K01	DIO,SHT SRT14 -A5
&1	D302	48T02162K01	DIO,SHT SRT14 -A5
#2	D302	48T02162K01	DIO,SHT SRT14 -A5
#1	D303	48T85270W01	DIO,MPG06G -A5
\$1	D303	48T85270W01	DIO,MPG06G -A5
%1	D303	48T02162K01	DIO,SHT SRT14 -A5
&1	D303	48T02162K01	DIO,SHT SRT14 -A5
#2	D303	48T02162K01	DIO,SHT SRT14 -A5
#1	D304	48T85270W01	DIO,MPG06G -A5
\$1	D304	48T85270W01	DIO,MPG06G -A5
%1	D304	48T02162K01	DIO,SHT SRT14 -A5
&1	D304	48T02162K01	DIO,SHT SRT14 -A5
#2	D304	48T02162K01	DIO,SHT SRT14 -A5
#1	D305	48T85270W01	DIO,MPG06G -A5
\$1	D305	48T85270W01	DIO,MPG06G -A5
%1	D305	48T02162K01	DIO,SHT SRT14 -A5
&1	D305	48T02162K01	DIO,SHT SRT14 -A5
#2	D305	48T02162K01	DIO,SHT SRT14 -A5
#1	D306	48T85270W01	DIO,MPG06G -A5
\$1	D306	48T85270W01	DIO,MPG06G -A5
%1	D306	48T02162K01	DIO,SHT SRT14 -A5
&1	D306	48T02162K01	DIO,SHT SRT14 -A5
#2	D306	48T02162K01	DIO,SHT SRT14 -A5
#1	D307	48T85270W01	DIO,MPG06G -A5
\$1	D307	48T85270W01	DIO,MPG06G -A5
%1	D307	48T02162K01	DIO,SHT SRT14 -A5
&1	D307	48T02162K01	DIO,SHT SRT14 -A5
#2	D307	48T02162K01	DIO,SHT SRT14 -A5
#1	D308	48T85270W01	DIO,MPG06G -A5
\$1	D308	48T85270W01	DIO,MPG06G -A5
%1	D308	48T02162K01	DIO,SHT SRT14 -A5
&1	D308	48T02162K01	DIO,SHT SRT14 -A5
#2	D308	48T02162K01	DIO,SHT SRT14 -A5
#1	D601	48T68828F01	DIO,1SS133 -A5
\$1	D601	48T68828F01	DIO,1SS133 -A5

**CDM-9823R/CDM-9823RR/CDE-9822RB/
CDE-9821R/CDE-9823RM**

	D602	48T63462F01	DIO,CP.DAN202K	-96
	D653	48T68828F01	DIO,1SS133	-A5
	D662	48T63462F01	DIO,CP.DAN202K	-96
	D701	48T25665Y01	DIO,1SS355-TE17	-CP
	D702	48T25665Y01	DIO,1SS355-TE17	-CP
	D703	48T25665Y01	DIO,1SS355-TE17	-CP
	D751	48T85269W01	DIO,SHT SB040	-A5
	D804	48T85270W01	DIO,MPG06G	-A5
	D861	48T68828F01	DIO,1SS133	-A5
	D862	48T25665Y01	DIO,1SS355-TE17	-CP
	E001	23S75373W13	CAP,ELY 1R0-1H	-R2
	E002	23S75373W02	CAP,ELY 10R-1C	-R2
	E003	23S75373W04	CAP,ELY 33R-1C	-R2
	E005	23S75373W05	CAP,ELY 47R-1C	-R2
	E006	23S75373W05	CAP,ELY 47R-1C	-R2
	E008	23S75373W13	CAP,ELY 1R0-1H	-R2
	E010	23S75373W13	CAP,ELY 1R0-1H	-R2
	E011	23S75373W02	CAP,ELY 10R-1C	-R2
	E013	23S75372W03	CAP,ELY 221-1A	-H2
	E016	23S75373W05	CAP,ELY 47R-1C	-R2
	E017	23S82372F13	CAP,ELY.2R2-1V-BP-R2	
	E018	23S65134W32	CAP,ELY 22R-1C(5)-E3	
	E019	23S75373W14	CAP,ELY 2R2-1H	-R2
	E020	23S75373W03	CAP,ELY 22R-1C	-R2
	E201	23S75373W05	CAP,ELY 47R-1C	-R2
	E202	23S75373W06	CAP,ELY 101-1C	-R2
#1	E203	23S75373W14	CAP,ELY 2R2-1H	-R2
\$1	E203	23S75373W14	CAP,ELY 2R2-1H	-R2
#1	E204	23S75373W14	CAP,ELY 2R2-1H	-R2
\$1	E204	23S75373W14	CAP,ELY 2R2-1H	-R2
#1	E205	23S75373W14	CAP,ELY 2R2-1H	-R2
\$1	E205	23S75373W14	CAP,ELY 2R2-1H	-R2
	E211	23S75373W13	CAP,ELY 1R0-1H	-R2
	E212	23S75373W13	CAP,ELY 1R0-1H	-R2
	E213	23S75373W13	CAP,ELY 1R0-1H	-R2
	E214	23S75373W13	CAP,ELY 1R0-1H	-R2
	E215	23S75373W13	CAP,ELY 1R0-1H	-R2
	E216	23S75373W13	CAP,ELY 1R0-1H	-R2
#1	E241	23S75373W03	CAP,ELY 22R-1C	-R2
\$1	E241	23S75373W03	CAP,ELY 22R-1C	-R2
#1	E261	23S75373W14	CAP,ELY 2R2-1H	-R2
\$1	E261	23S75373W14	CAP,ELY 2R2-1H	-R2
#1	E262	23S75373W14	CAP,ELY 2R2-1H	-R2
\$1	E262	23S75373W14	CAP,ELY 2R2-1H	-R2
	E263	23S75373W14	CAP,ELY 2R2-1H	-R2
	E264	23S75373W14	CAP,ELY 2R2-1H	-R2
	E302	23S95415W14	CAP,ELY R22-1H	-R2
	E303	23S95415W03	CAP,ELY 10R-1C	-R2
	E304	23S95415W17	CAP,ELY 1R0-1H	-R2
	E311	23S75373W02	CAP,ELY 10R-1C	-R2
	E312	23S75373W02	CAP,ELY 10R-1C	-R2
	E313	23S75373W02	CAP,ELY 10R-1C	-R2
	E314	23S75373W02	CAP,ELY 10R-1C	-R2
	E601	23S75373W03	CAP,ELY 22R-1C	-R2
	E602	23S75372W03	CAP,ELY 221-1A	-H2
%1	E604	23S75373W02	CAP,ELY 10R-1C	-R2
	E651	23S75373W04	CAP,ELY 33R-1C	-R2

**CDM-9823R/CDM-9823RR/CDE-9822RB/
CDE-9821R/CDE-9823RM**

E701	23S75372W07	CAP,ELY 47R-1C -R2
E703	23S55311W35	CAP,TAN 10R-1C-B -CP
E704	23S75373W05	CAP,ELY 47R-1C -R2
E707	23S75373W02	CAP,ELY 10R-1C -R2
E716	23S75373W05	CAP,ELY 47R-1C -R2
E717	23S75373W03	CAP,ELY 22R-1C -R2
E729	23S55311W28	CAP,TAN 22R-1A-B -CP
E733	23S75373W02	CAP,ELY 10R-1C -R2
E735	23S55311W31	CAP,TAN.2R2-1C-A -CP
E736	23S55311W35	CAP,TAN 10R-1C-B -CP
E737	23S65134W34	CAP,ELY 47R-1C(6)-E6
E738	23S55311W35	CAP,TAN 10R-1C-B -CP
E751	23S75373W02	CAP,ELY 10R-1C -R2
E752	23T55378W03	CAP,KMG 471-1A -R2
E800	23S75373W13	CAP,ELY 1R0-1H -R2
E801	23T75346W03	CAP,X-PRO 332-1C +
E803	23S75372W03	CAP,ELY 221-1A -H2
E804	23S75373W04	CAP,ELY 33R-1C -R2
E805	23S75373W13	CAP,ELY 1R0-1H -R2
E842	23S75373W06	CAP,ELY 101-1C -R2
E861	23S75373W05	CAP,ELY 47R-1C -R2
IC002	51T40941U02	IC ,MC14066BFEL-SE06
IC003	51T85265W02	LC72191JM -SE9
IC004	51T15132Y02	SAA6588T -SE9
IC006	51T93333F01	NJM2904M-TE3 -SE2
IC007	51T15419Y02	BA4558F-E2 -SE2
IC201	51T35261Y01	TDA7404 -SE9
#1 IC203	51T15420Y01	BA4560F-E2 -SE2
\$1 IC203	51T15420Y01	BA4560F-E2 -SE2
#1 IC301	51T55148Y01	TA8273H -ZS
\$1 IC301	51T55148Y01	TA8273H -ZS
%1 IC301	51T45409Y01	TA8263BH -ZS
&1 IC301	51T45409Y01	TA8263BH -ZS
#2 IC301	51T45409Y01	TA8263BH -ZS
IC601	51T75301Y01	IC,D784216AGF-540-QT
IC602	51T65016Y19	S-80930CNMC-T2 -CP
IC651	51T95193W01	TDA3606AT -SE9
IC701	51T55093Y01	BA5984FP-E2 -SEA
IC702	51T55156Y01	UPD63711A -QT
IC703	51T55329Y02	IC,D789026GB-A82 -QT
IC704	51T55295Y01	AN80M50RSPE1 -NE5
IC751	51T15510W01	IC ,MC34063AML -SPD
J007	06S35095Y08	RES,RK JUMPER 1/4-CP
J023	06S35095Y08	RES,RK JUMPER 1/4-CP
J029	06S35095Y08	RES,RK JUMPER 1/4-CP
L001	24T65053W18	IND,LAL02VD 4R7K -R5
L002	24T16403W29	COI,IND.15R-M -CP
L601	24T65053W18	IND,LAL02VD 4R7K -R5
L602	24T65053W18	IND,LAL02VD 4R7K -R5
L651	24T25164Y21	IND,FSLM2520 4R7J-CP
L751	24T16271W13	COIL,RCR875D-221K
L801	25T01879K01	CHOKE,LAT1608-105-DB
PS801	48T95226W01	TMT,PTGL05BA1R8M1-R5
Q001	48T93828F04	TR,2SD1994A-S-TA -RD
Q002	48T93828F04	TR,2SD1994A-S-TA -RD
Q003	48T93828F04	TR,2SD1994A-S-TA -RD
Q004	48T94875F04	DTB,CP-123YK-96

**CDM-9823R/CDM-9823RR/CDE-9822RB/
CDE-9821R/CDE-9823RM**

	Q005	48T52438F01	TR ,2SD601A-RS/TX-CP
	Q006	48T52438F01	TR ,2SD601A-RS/TX-CP
	Q009	48T73888F08	TR ,CP.FMG1-99
	Q010	48T62967F03	TR,DTC124EKA-T146-CP
	Q011	48T62967F03	TR,DTC124EKA-T146-CP
	Q012	48T73888F12	TR ,CP.FMC2-99
	Q013	48T73888F13	TR ,CP FMC3-99
	Q015	48T62967F33	TR,DTC343TK-T146 -CP
	Q201	48T62967F03	TR,DTC124EKA-T146-CP
#1	Q261	48T62967F33	TR,DTC343TK-T146 -CP
\$1	Q261	48T62967F33	TR,DTC343TK-T146 -CP
#1	Q262	48T62967F33	TR,DTC343TK-T146 -CP
\$1	Q262	48T62967F33	TR,DTC343TK-T146 -CP
	Q263	48T62967F33	TR,DTC343TK-T146 -CP
	Q264	48T62967F33	TR,DTC343TK-T146 -CP
	Q301	48T62967F03	TR,DTC124EKA-T146-CP
#1	Q601	48T62966F03	TR,DTA124EKA-T146-CP
\$1	Q601	48T62966F03	TR,DTA124EKA-T146-CP
#1	Q602	48T73888F08	TR ,CP.FMG1-99
\$1	Q602	48T73888F08	TR ,CP.FMG1-99
	Q604	48T73888F13	TR ,CP FMC3-99
	Q607	48T62967F02	TR,DTC114EKA-T146-CP
%1	Q608	48T64222F02	TR ,UN2212 22-22 -TX
	Q651	48T73888F12	TR ,CP.FMC2-99
	Q652	48T73888F12	TR ,CP.FMC2-99
	Q664	48T62966F01	TR,DTA143EKA-T146-CP
	Q701	48T55462Y01	TR,2SB1132-QR-100-E2
	Q702	48T94606F03	TR,DTC124EUA-T106-CP
	Q751	48T15511W02	CP.2SB1261-TE2 -E5
	Q752	48T73888F12	TR ,CP.FMC2-99
	Q803	48T84366F04	TR,2SB1243-QR-TV2-RD
	Q804	48T62967F05	TR,DTC143XKA-T146-CP
	Q805	48T69176F02	TR ,2SC3421-Y
	Q807	48T92368F04	TR,2SD1760 R -E5
	Q862	48T73888F12	TR ,CP.FMC2-99
	Q863	48T62967F03	TR,DTC124EKA-T146-CP
	R001	06S70072F05	RES,CP .10R-J-1/4-CP
	R002	06S70072F78	RES,CP .2R2-J-1/4-CP
	R003	06S70072F78	RES,CP .2R2-J-1/4-CP
	R004	06S70072F65	RES,CP .332-J-1/4-CP
	R005	06S70072F69	RES,CP .472-J-1/4-CP
	R006	06S70072F69	RES,CP .472-J-1/4-CP
	R007	06S45674W81	RES,RK 103J 1/10 -CP
	R008	06S45674W95	RES,RK 393J 1/10 -CP
	R009	06S70072F29	RES,CP .101-J-1/4-CP
	R010	06S45674W81	RES,RK 103J 1/10 -CP
	R011	06S45674W81	RES,RK 103J 1/10 -CP
	R012	06S45674W81	RES,RK 103J 1/10 -CP
	R013	06S45674W69	RES,RK 332J 1/10 -CP
	R014	06S45675W02	RES,RK 683J 1/10 -CP
	R015	06S45674W81	RES,RK 103J 1/10 -CP
	R016	06S64995F61	RES,RK 222J 1/8 -CP
	R017	06S45674W97	RES,RK 473J 1/10 -CP
	R018	06S45674W81	RES,RK 103J 1/10 -CP
	R021	06S45674W57	RES,RK 102J 1/10 -CP
	R025	06S45675W43	RES,RK JUMPER1/10-CP
	R028	06S64995F89	RES,RK 333J 1/8 -CP

**CDM-9823R/CDM-9823RR/CDE-9822RB/
CDE-9821R/CDE-9823RM**

	R029	06S45674W81	RES,RK 103J 1/10 -CP
	R030	06S45674W97	RES,RK 473J 1/10 -CP
	R031	06S45675W43	RES,RK JUMPER1/10-CP
	R032	06S45675W43	RES,RK JUMPER1/10-CP
	R035	06S45674W95	RES,RK 393J 1/10 -CP
	R042	06S70072F41	RES,CP .331-J-1/4-CP
	R049	06S45674W57	RES,RK 102J 1/10 -CP
	R050	06S45674W71	RES,RK 392J 1/10 -CP
	R051	06S45674W25	RES,RK 47RJ 1/10 -CP
	R052	06S45674W89	RES,RK 223J 1/10 -CP
	R053	06S45674W87	RES,RK 183J 1/10 -CP
	R054	06S45674W57	RES,RK 102J 1/10 -CP
	R055	06S45674W65	RES,RK 222J 1/10 -CP
	R056	06S45674W57	RES,RK 102J 1/10 -CP
	R057	06S45675W43	RES,RK JUMPER1/10-CP
	R059	06S45674W81	RES,RK 103J 1/10 -CP
	R060	06S45674W65	RES,RK 222J 1/10 -CP
	R061	06S45674W81	RES,RK 103J 1/10 -CP
	R062	06S45674W81	RES,RK 103J 1/10 -CP
	R063	06S45674W09	RES,RK 10RJ 1/10 -CP
	R065	06S45674W75	RES,RK 562J 1/10 -CP
	R066	06S45674W75	RES,RK 562J 1/10 -CP
	R067	06S45674W57	RES,RK 102J 1/10 -CP
	R068	06S45674W57	RES,RK 102J 1/10 -CP
	R069	06S45674W73	RES,RK 472J 1/10 -CP
	R071	06S45675W22	RES,RK 474J 1/10 -CP
	R073	06S45674W81	RES,RK 103J 1/10 -CP
	R103	06S70072F47	RES,CP .561-J-1/4-CP
	R104	06S70072F47	RES,CP .561-J-1/4-CP
	R201	06S45674W77	RES,RK 682J 1/10 -CP
	R204	06S45674W57	RES,RK 102J 1/10 -CP
	R205	06S45674W57	RES,RK 102J 1/10 -CP
#1	R241	06S45674W60	RES,RK 132J 1/10 -CP
\$1	R241	06S45674W60	RES,RK 132J 1/10 -CP
#1	R242	06S45674W60	RES,RK 132J 1/10 -CP
\$1	R242	06S45674W60	RES,RK 132J 1/10 -CP
#1	R261	06S45674W40	RES,RK 201J 1/10 -CP
\$1	R261	06S45674W40	RES,RK 201J 1/10 -CP
#1	R262	06S45674W40	RES,RK 201J 1/10 -CP
\$1	R262	06S45674W40	RES,RK 201J 1/10 -CP
#1	R263	06S45674W98	RES,RK 513J 1/10 -CP
\$1	R263	06S45674W98	RES,RK 513J 1/10 -CP
#1	R264	06S45674W98	RES,RK 513J 1/10 -CP
\$1	R264	06S45674W98	RES,RK 513J 1/10 -CP
#1	R265	06S45674W33	RES,RK 101J 1/10 -CP
\$1	R265	06S45674W33	RES,RK 101J 1/10 -CP
#1	R266	06S45674W33	RES,RK 101J 1/10 -CP
\$1	R266	06S45674W33	RES,RK 101J 1/10 -CP
	R267	06S45674W40	RES,RK 201J 1/10 -CP
	R268	06S45674W40	RES,RK 201J 1/10 -CP
	R269	06S45674W33	RES,RK 101J 1/10 -CP
	R270	06S45674W98	RES,RK 513J 1/10 -CP
	R271	06S45674W98	RES,RK 513J 1/10 -CP
	R272	06S45674W33	RES,RK 101J 1/10 -CP
	R305	06S70072F77	RES,CP .103-J-1/4-CP
%1	R311	06S45675W43	RES,RK JUMPER1/10-CP
&1	R311	06S45675W43	RES,RK JUMPER1/10-CP

**CDM-9823R/CDM-9823RR/CDE-9822RB/
CDE-9821R/CDE-9823RM**

#2	R311	06S45675W43	RES,RK JUMPER1/10-CP
%1	R312	06S45675W43	RES,RK JUMPER1/10-CP
&1	R312	06S45675W43	RES,RK JUMPER1/10-CP
#2	R312	06S45675W43	RES,RK JUMPER1/10-CP
	R399	06S45675W43	RES,RK JUMPER1/10-CP
	R600	06S45674W97	RES,RK 473J 1/10 -CP
	R603	06S64995F79	RES,RK 123J 1/8 -CP
	R604	06S45674W89	RES,RK 223J 1/10 -CP
	R605	06S45674W97	RES,RK 473J 1/10 -CP
	R606	06S45674W57	RES,RK 102J 1/10 -CP
	R607	06S45674W81	RES,RK 103J 1/10 -CP
	R608	06S64995F77	RES,RK 103J 1/8 -CP
	R609	06T45541Y01	RES,RS 12RJ 2W -
	R611	06S15593Y97	RES,RK 104F 1/10 -CP
	R612	06S64995F53	RES,RK 102J 1/8 -CP
	R613	06S64995F53	RES,RK 102J 1/8 -CP
	R614	06S64995F53	RES,RK 102J 1/8 -CP
	R615	06S64995F53	RES,RK 102J 1/8 -CP
	R616	06S64995F53	RES,RK 102J 1/8 -CP
	R617	06S64995F53	RES,RK 102J 1/8 -CP
	R618	06S45675W43	RES,RK JUMPER1/10-CP
	R619	06S45674W57	RES,RK 102J 1/10 -CP
	R620	06S45674W57	RES,RK 102J 1/10 -CP
	R621	06S45674W81	RES,RK 103J 1/10 -CP
	R623	06S45674W57	RES,RK 102J 1/10 -CP
	R625	06S45674W81	RES,RK 103J 1/10 -CP
	R626	06S45674W81	RES,RK 103J 1/10 -CP
	R627	06S45674W69	RES,RK 332J 1/10 -CP
	R628	06S15594Y04	RES,RK 184F 1/10 -CP
	R629	06S45674W97	RES,RK 473J 1/10 -CP
	R630	06S45674W89	RES,RK 223J 1/10 -CP
#1	R631	06S70072F98	RES,RK 223J 1/4 -CP
\$1	R631	06S70072F98	RES,RK 223J 1/4 -CP
#1	R632	06S70072F37	RES,CP .221-J-1/4-CP
\$1	R632	06S70072F37	RES,CP .221-J-1/4-CP
	R633	06S45674W97	RES,RK 473J 1/10 -CP
	R634	06S45674W43	RES,RK 271J 1/10 -CP
	R635	06S45674W43	RES,RK 271J 1/10 -CP
	R636	06S64995F93	RES,RK 473J 1/8 -CP
	R638	06S45674W83	RES,RK 123J 1/10 -CP
	R639	06S45674W89	RES,RK 223J 1/10 -CP
	R640	06S45675W22	RES,RK 474J 1/10 -CP
	R641	06S70072F98	RES,RK 223J 1/4 -CP
	R642	06S45674W57	RES,RK 102J 1/10 -CP
	R644	06S64995F93	RES,RK 473J 1/8 -CP
	R645	06S70072F29	RES,CP .101-J-1/4-CP
	R646	06S64995F69	RES,RK 472J 1/8 -CP
	R647	06S64995F69	RES,RK 472J 1/8 -CP
	R649	06S70072F63	RES,CP .272-J-1/4-CP
	R650	06S15593Y73	RES,RK 103F 1/10 -CP
	R651	06S45674W99	RES,RK 563J 1/10 -CP
	R653	06S15593Y63	RES,RK 392F 1/10 -CP
	R654	06S70072F69	RES,CP .472-J-1/4-CP
	R655	06S70072F69	RES,CP .472-J-1/4-CP
	R656	06S64996F14	RES,RK 334J 1/8 -CP
	R657	06S15593Y99	RES,RK 124F 1/10 -CP
	R658	06S15593Y97	RES,RK 104F 1/10 -CP

**CDM-9823R/CDM-9823RR/CDE-9822RB/
CDE-9821R/CDE-9823RM**

%1	R659	06S70072F77	RES,CP .103-J-1/4-CP
	R660	06S70072F77	RES,CP .103-J-1/4-CP
%1	R661	06S70072F98	RES,RK 223J 1/4 -CP
&1	R661	06S70072F98	RES,RK 223J 1/4 -CP
#2	R661	06S70072F98	RES,RK 223J 1/4 -CP
#1	R662	06S45674W83	RES,RK 123J 1/10 -CP
\$1	R662	06S45674W83	RES,RK 123J 1/10 -CP
#1	R663	06S70072F98	RES,RK 223J 1/4 -CP
\$1	R663	06S70072F98	RES,RK 223J 1/4 -CP
	R664	06S64995F93	RES,RK 473J 1/8 -CP
%1	R665	06S64995F85	RES,RK 223J 1/8 -CP
&1	R665	06S64995F85	RES,RK 223J 1/8 -CP
#2	R665	06S64995F85	RES,RK 223J 1/8 -CP
	R666	06S64996F39	RES,RK JUMPER 1/8-CP
	R667	06S64996F39	RES,RK JUMPER 1/8-CP
	R668	06S64996F39	RES,RK JUMPER 1/8-CP
	R669	06S64996F39	RES,RK JUMPER 1/8-CP
	R670	06S64996F39	RES,RK JUMPER 1/8-CP
\$1	R671	06S70072F77	RES,CP .103-J-1/4-CP
#1	R672	06S45674W83	RES,RK 123J 1/10 -CP
%1	R672	06S45674W83	RES,RK 123J 1/10 -CP
&1	R672	06S45674W83	RES,RK 123J 1/10 -CP
#2	R672	06S45674W83	RES,RK 123J 1/10 -CP
	R686	06S45674W65	RES,RK 222J 1/10 -CP
	R701	06S70072F05	RES,CP .10R-J-1/4-CP
	R702	06S70072F05	RES,CP .10R-J-1/4-CP
	R703	06S45674W97	RES,RK 473J 1/10 -CP
	R704	06S45674W95	RES,RK 393J 1/10 -CP
	R705	06S45674W85	RES,RK 153J 1/10 -CP
	R706	06S45674W81	RES,RK 103J 1/10 -CP
	R707	06S45674W81	RES,RK 103J 1/10 -CP
	R708	06S45674W89	RES,RK 223J 1/10 -CP
	R709	06S45674W81	RES,RK 103J 1/10 -CP
	R710	06S45674W81	RES,RK 103J 1/10 -CP
	R711	06S45674W89	RES,RK 223J 1/10 -CP
	R712	06S45674W97	RES,RK 473J 1/10 -CP
	R713	06S45674W97	RES,RK 473J 1/10 -CP
	R716	06S45674W41	RES,RK 221J 1/10 -CP
	R717	06S45674W41	RES,RK 221J 1/10 -CP
	R718	06S45674W97	RES,RK 473J 1/10 -CP
	R719	06S45674W97	RES,RK 473J 1/10 -CP
	R722	06S45674W97	RES,RK 473J 1/10 -CP
	R723	06S45674W81	RES,RK 103J 1/10 -CP
	R724	06S45674W95	RES,RK 393J 1/10 -CP
	R725	06S64995F74	RES,RK 752J 1/8 -CP
	R726	06S45674W33	RES,RK 101J 1/10 -CP
	R727	06S45674W91	RES,RK 273J 1/10 -CP
	R728	06S45675W06	RES,RK 104J 1/10 -CP
	R729	06S45674W97	RES,RK 473J 1/10 -CP
	R732	06S45674W97	RES,RK 473J 1/10 -CP
	R733	06S45674W97	RES,RK 473J 1/10 -CP
	R734	06S45674W33	RES,RK 101J 1/10 -CP
	R735	06S45674W33	RES,RK 101J 1/10 -CP
	R736	06S70072F29	RES,CP .101-J-1/4-CP
	R737	06S70072F29	RES,CP .101-J-1/4-CP
	R740	06S45674W97	RES,RK 473J 1/10 -CP
	R741	06S45675W43	RES,RK JUMPER1/10-CP

**CDM-9823R/CDM-9823RR/CDE-9822RB/
CDE-9821R/CDE-9823RM**

	R743	06S45674W93	RES,RK 333J 1/10 -CP
	R744	06S45674W93	RES,RK 333J 1/10 -CP
	R745	06S45674W93	RES,RK 333J 1/10 -CP
	R746	06S45674W97	RES,RK 473J 1/10 -CP
	R747	06S45674W93	RES,RK 333J 1/10 -CP
	R748	06S45674W97	RES,RK 473J 1/10 -CP
	R750	06S45675W43	RES,RK JUMPER1/10-CP
	R751	06S45674W81	RES,RK 103J 1/10 -CP
	R752	06S45674W97	RES,RK 473J 1/10 -CP
	R753	06S45674W97	RES,RK 473J 1/10 -CP
	R754	06S45674W97	RES,RK 473J 1/10 -CP
	R755	06S45674W97	RES,RK 473J 1/10 -CP
	R756	06S45674W97	RES,RK 473J 1/10 -CP
	R757	06S45674W97	RES,RK 473J 1/10 -CP
	R758	06S45674W97	RES,RK 473J 1/10 -CP
	R759	06S45674W93	RES,RK 333J 1/10 -CP
	R760	06S45674W33	RES,RK 101J 1/10 -CP
	R761	06S45674W33	RES,RK 101J 1/10 -CP
	R762	06S45674W97	RES,RK 473J 1/10 -CP
	R764	06S45674W97	RES,RK 473J 1/10 -CP
	R765	06S70072F29	RES,CP .101-J-1/4-CP
	R767	06S70072F47	RES,CP .561-J-1/4-CP
	R768	06S70072F47	RES,CP .561-J-1/4-CP
	R769	06S35084Y41	RES,RK 223F 1/8 -CP
	R770	06S35084Y33	RES,RK 472F 1/8 -CP
	R771	06S45675W21	RES,RK 434J 1/10 -CP
#1	R801	06S70072F53	RES,CP .102-J-1/4-CP
\$1	R801	06S70072F53	RES,CP .102-J-1/4-CP
	R802	06S70072F77	RES,CP .103-J-1/4-CP
	R803	06S45675W06	RES,RK 104J 1/10 -CP
	R804	06S35095Y15	RES,RK 243J 1/4 -CP
	R805	06S70072F59	RES,CP .182-J-1/4-CP
	R806	06S70072F59	RES,CP .182-J-1/4-CP
	R807	06S70072F51	RES,CP .821-J-1/4-CP
	R808	06S70072F45	RES,CP .471-J-1/4-CP
	R812	06S70072F57	RES,CP .152-J-1/4-CP
	R813	06S70072F57	RES,CP .152-J-1/4-CP
	R830	06S35095Y08	RES,RK JUMPER 1/4-CP
	R833	06S70072F77	RES,CP .103-J-1/4-CP
	R864	06S45674W81	RES,RK 103J 1/10 -CP
	R865	06S45675W16	RES,RK 274J 1/10 -CP
	R867	06S70072F29	RES,CP .101-J-1/4-CP
	RA701	06S45591W07	RES,ARY MNR101J 4-CP
	RA702	06S45591W07	RES,ARY MNR101J 4-CP
	SA001	48T81909F01	PTT,DSP-201M -A1
	SD801	48T68580F03	DIO,SI DSA3A4-F5
#1	WTB201	01T01877K03	ASSY,CONN RCA 9803R
\$1	WTB201	01T01877K03	ASSY,CONN RCA 9803R
%1	WTB202	01T01877K04	ASSY,CONN RCA 9801R
&1	WTB202	01T01877K04	ASSY,CONN RCA 9801R
#2	WTB202	01T01877K04	ASSY,CONN RCA 9801R
	XL001	91T25806W43	XTL,7.200M -AT51-TP
	XL002	91T25806W18	XTL,4.332M -AT51-TP
	XL601	91T55360Y03	XTL,AT-51 12.288M-R5
	Z601	91T65112W06	EMI,BK2125HM102 -CP
	ZD001	48T83128F23	DIO,ZEN.HZS 9B2L -A5
	ZD002	48T83128F04	DIO,ZEN.HZS 6B1L -A5

**CDM-9823R/CDM-9823RR/CDE-9822RB/
CDE-9821R/CDE-9823RM**

ZD003	48T83128F40	DIO,ZEN.HZS12B1L -A5
ZD652	48T83128F14	DIO,ZEN HZS 7B2L -A5
ZD802	48T83128F25	DIO,ZEN.HZS 9C1L -A5
ZD803	48T83128F26	DIO,ZEN.HZS 9C2L -A5

=====FRONT P.W.Board

	C401	08S45676W89	CAP,CER 473K-B1E -CP
	C402	08S45676W89	CAP,CER 473K-B1E -CP
	C403	08S45676W89	CAP,CER 473K-B1E -CP
	C404	08S45677W58	CAP,CER 821J-CH1H-CP
	C406	08S65128F78	CAP,CER.223K-B1H -CP
	C407	08S65128F78	CAP,CER.223K-B1H -CP
	D401	48T81063F01	DIO,CP.MA159 / TX-CP
	D402	48T81063F01	DIO,CP.MA159 / TX-CP
	D404	48T85357W01	DIO,1PS226 -CP
	D405	48T85357W01	DIO,1PS226 -CP
	D406	48T85357W01	DIO,1PS226 -CP
	D407	48T85357W01	DIO,1PS226 -CP
	D408	48T85357W01	DIO,1PS226 -CP
	IC401	51T02347K01	PT6583LQ -QT
%1	LD401	48T65708Y01	LED,WHT UW1149B -E1
%1	LD402	48T65708Y01	LED,WHT UW1149B -E1
%1	LD403	48T65708Y01	LED,WHT UW1149B -E1
%1	LD404	48T65708Y01	LED,WHT UW1149B -E1
\$1	LD405	48T25534Y02	LED,RED BR1111C -CP
%1	LD405	48T25534Y02	LED,RED BR1111C -CP
#2	LD405	48T25534Y03	LED,AMB AA1111C -CP
\$1	LD406	48T25534Y02	LED,RED BR1111C -CP
%1	LD406	48T25534Y02	LED,RED BR1111C -CP
#2	LD406	48T25534Y03	LED,AMB AA1111C -CP
#1	LD407	48T25534Y01	LED,GRN BG1111C -CP
\$1	LD407	48T25534Y02	LED,RED BR1111C -CP
%1	LD407	48T25534Y02	LED,RED BR1111C -CP
&1	LD407	48T25534Y01	LED,GRN BG1111C -CP
#2	LD407	48T25534Y03	LED,AMB AA1111C -CP
#1	LD408	48T25534Y01	LED,GRN BG1111C -CP
\$1	LD408	48T25534Y02	LED,RED BR1111C -CP
%1	LD408	48T25534Y02	LED,RED BR1111C -CP
&1	LD408	48T25534Y01	LED,GRN BG1111C -CP
#2	LD408	48T25534Y03	LED,AMB AA1111C -CP
#1	LD409	48T25534Y01	LED,GRN BG1111C -CP
\$1	LD409	48T25534Y02	LED,RED BR1111C -CP
%1	LD409	48T25534Y02	LED,RED BR1111C -CP
&1	LD409	48T25534Y01	LED,GRN BG1111C -CP
#2	LD409	48T25534Y03	LED,AMB AA1111C -CP
#1	LD410	48T25534Y01	LED,GRN BG1111C -CP
\$1	LD410	48T25534Y02	LED,RED BR1111C -CP
%1	LD410	48T25534Y02	LED,RED BR1111C -CP
&1	LD410	48T25534Y01	LED,GRN BG1111C -CP
#2	LD410	48T25534Y03	LED,AMB AA1111C -CP
\$1	LD411	48T25534Y02	LED,RED BR1111C -CP
%1	LD411	48T25534Y02	LED,RED BR1111C -CP
#2	LD411	48T25534Y03	LED,AMB AA1111C -CP
\$1	LD412	48T25534Y02	LED,RED BR1111C -CP
%1	LD412	48T25534Y02	LED,RED BR1111C -CP
#2	LD412	48T25534Y03	LED,AMB AA1111C -CP
\$1	LD413	48T25534Y02	LED,RED BR1111C -CP

**CDM-9823R/CDM-9823RR/CDE-9822RB/
CDE-9821R/CDE-9823RM**

%1	LD413	48T25534Y02	LED,RED BR1111C	-CP
#2	LD413	48T25534Y03	LED,AMB AA1111C	-CP
#1	LD415	48T25534Y01	LED,GRN BG1111C	-CP
\$1	LD415	48T25534Y02	LED,RED BR1111C	-CP
%1	LD415	48T25534Y02	LED,RED BR1111C	-CP
&1	LD415	48T25534Y01	LED,GRN BG1111C	-CP
#2	LD415	48T25534Y03	LED,AMB AA1111C	-CP
#1	LD416	48T25534Y01	LED,GRN BG1111C	-CP
\$1	LD416	48T25534Y02	LED,RED BR1111C	-CP
%1	LD416	48T25534Y02	LED,RED BR1111C	-CP
&1	LD416	48T25534Y01	LED,GRN BG1111C	-CP
#2	LD416	48T25534Y03	LED,AMB AA1111C	-CP
#1	LD417	48T25534Y01	LED,GRN BG1111C	-CP
\$1	LD417	48T25534Y02	LED,RED BR1111C	-CP
%1	LD417	48T25534Y02	LED,RED BR1111C	-CP
&1	LD417	48T25534Y01	LED,GRN BG1111C	-CP
#2	LD417	48T25534Y03	LED,AMB AA1111C	-CP
\$1	LD418	48T25534Y02	LED,RED BR1111C	-CP
%1	LD418	48T25534Y02	LED,RED BR1111C	-CP
#2	LD418	48T25534Y03	LED,AMB AA1111C	-CP
#1	LD419	48T25534Y01	LED,GRN BG1111C	-CP
\$1	LD419	48T25534Y02	LED,RED BR1111C	-CP
%1	LD419	48T25534Y02	LED,RED BR1111C	-CP
&1	LD419	48T25534Y01	LED,GRN BG1111C	-CP
#2	LD419	48T25534Y03	LED,AMB AA1111C	-CP
#1	LD420	48T25534Y01	LED,GRN BG1111C	-CP
\$1	LD420	48T25534Y02	LED,RED BR1111C	-CP
%1	LD420	48T25534Y02	LED,RED BR1111C	-CP
&1	LD420	48T25534Y01	LED,GRN BG1111C	-CP
#2	LD420	48T25534Y03	LED,AMB AA1111C	-CP
%1	LD421	48T25534Y11	LED,BLU EB1111C	-CP
%1	LD422	48T25534Y11	LED,BLU EB1111C	-CP
%1	LD423	48T25534Y11	LED,BLU EB1111C	-CP
%1	LD425	48T25534Y11	LED,BLU EB1111C	-CP
#1	LD427	48T25534Y03	LED,AMB AA1111C	-CP
\$1	LD427	48T25534Y02	LED,RED BR1111C	-CP
%1	LD427	48T25534Y02	LED,RED BR1111C	-CP
&1	LD427	48T25534Y03	LED,AMB AA1111C	-CP
#2	LD427	48T25534Y03	LED,AMB AA1111C	-CP
#1	PL401	65T45309Y03	LAMP,CLRGRN 9-100-E5	
\$1	PL401	65T45309Y04	LAMP,RED 9-100	-E5
&1	PL401	65T45309Y01	LAMP,GRN 9-100	-E5
#2	PL401	65T45309Y02	LAMP,AMB 9-100	-E5
#1	PL402	65T45309Y03	LAMP,CLRGRN 9-100-E5	
\$1	PL402	65T45309Y04	LAMP,RED 9-100	-E5
&1	PL402	65T45309Y01	LAMP,GRN 9-100	-E5
#2	PL402	65T45309Y02	LAMP,AMB 9-100	-E5
#1	PL403	65T35324Y10	LAMP,GRN 6-80	-E5
&1	PL403	65T35324Y10	LAMP,GRN 6-80	-E5
#1	PL404	65T35324Y10	LAMP,GRN 6-80	-E5
\$1	PL404	65T35324Y09	LAMP,RED 6-80	-E5
&1	PL404	65T35324Y10	LAMP,GRN 6-80	-E5
#2	PL404	65T35324Y03	LAMP,AMB 6-80	-E5
#1	PL405	65T35324Y10	LAMP,GRN 6-80	-E5
&1	PL405	65T35324Y10	LAMP,GRN 6-80	-E5
#1	PL406	65T35324Y10	LAMP,GRN 6-80	-E5
&1	PL406	65T35324Y10	LAMP,GRN 6-80	-E5

**CDM-9823R/CDM-9823RR/CDE-9822RB/
CDE-9821R/CDE-9823RM**

%1	Q401	48T63788F04	TR ,CP.2SD1328-T -TX
	R401	06S45674W57	RES,RK 102J 1/10 -CP
	R402	06S45674W57	RES,RK 102J 1/10 -CP
	R403	06S45674W57	RES,RK 102J 1/10 -CP
	R404	06S45674W57	RES,RK 102J 1/10 -CP
	R405	06S45674W57	RES,RK 102J 1/10 -CP
	R406	06S45674W57	RES,RK 102J 1/10 -CP
	R407	06S45674W57	RES,RK 102J 1/10 -CP
	R408	06S45674W57	RES,RK 102J 1/10 -CP
	R409	06S45674W57	RES,RK 102J 1/10 -CP
	R410	06S45674W97	RES,RK 473J 1/10 -CP
	R411	06S45674W73	RES,RK 472J 1/10 -CP
	R412	06S45675W06	RES,RK 104J 1/10 -CP
	R413	06S45674W57	RES,RK 102J 1/10 -CP
	R414	06S45674W57	RES,RK 102J 1/10 -CP
	R415	06S45674W57	RES,RK 102J 1/10 -CP
	R416	06S45674W57	RES,RK 102J 1/10 -CP
	R417	06S45674W57	RES,RK 102J 1/10 -CP
#1	R418	06S35095Y08	RES,RK JUMPER 1/4-CP
\$1	R418	06S35095Y08	RES,RK JUMPER 1/4-CP
%1	R418	06S70072F27	RES,CP .82R-J-1/4-CP
&1	R418	06S35095Y08	RES,RK JUMPER 1/4-CP
#2	R418	06S35095Y08	RES,RK JUMPER 1/4-CP
#1	R419	06S35095Y08	RES,RK JUMPER 1/4-CP
\$1	R419	06S35095Y08	RES,RK JUMPER 1/4-CP
%1	R419	06S70072F27	RES,CP .82R-J-1/4-CP
&1	R419	06S35095Y08	RES,RK JUMPER 1/4-CP
#2	R419	06S35095Y08	RES,RK JUMPER 1/4-CP
%1	R420	06S45674W65	RES,RK 222J 1/10 -CP
%1	R421	06S70072F36	RES,CP .201-J-1/4-CP
%1	R423	06S70072F36	RES,CP .201-J-1/4-CP
#1	R424	06S70072F19	RES,CP .39R-J-1/4-CP
&1	R424	06S70072F19	RES,CP .39R-J-1/4-CP
%1	R425	06S70072F36	RES,CP .201-J-1/4-CP
%1	R427	06S70072F36	RES,CP .201-J-1/4-CP
#1	R428	06S70072F19	RES,CP .39R-J-1/4-CP
\$1	R428	06S70072F10	RES,CP .16R-J-1/4-CP
&1	R428	06S70072F19	RES,CP .39R-J-1/4-CP
#2	R428	06S70072F18	RES,CP .36R-J-1/4-CP
\$1	R429	06S70072F37	RES,CP .221-J-1/4-CP
%1	R429	06S70072F39	RES,CP .271-J-1/4-CP
#2	R429	06S70072F37	RES,CP .221-J-1/4-CP
\$1	R430	06S70072F37	RES,CP .221-J-1/4-CP
%1	R430	06S70072F37	RES,CP .221-J-1/4-CP
#2	R430	06S70072F37	RES,CP .221-J-1/4-CP
\$1	R431	06S70072F37	RES,CP .221-J-1/4-CP
%1	R431	06S70072F39	RES,CP .271-J-1/4-CP
#2	R431	06S70072F37	RES,CP .221-J-1/4-CP
\$1	R432	06S70072F37	RES,CP .221-J-1/4-CP
%1	R432	06S70072F37	RES,CP .221-J-1/4-CP
#2	R432	06S70072F37	RES,CP .221-J-1/4-CP
#1	R433	06S70072F39	RES,CP .271-J-1/4-CP
\$1	R433	06S70072F37	RES,CP .221-J-1/4-CP
%1	R433	06S70072F37	RES,CP .221-J-1/4-CP
&1	R433	06S70072F39	RES,CP .271-J-1/4-CP
#2	R433	06S70072F37	RES,CP .221-J-1/4-CP
#1	R434	06S70072F39	RES,CP .271-J-1/4-CP

**CDM-9823R/CDM-9823RR/CDE-9822RB/
CDE-9821R/CDE-9823RM**

\$1	R434	06S70072F39	RES,CP .271-J-1/4-CP
%1	R434	06S70072F41	RES,CP .331-J-1/4-CP
&1	R434	06S70072F39	RES,CP .271-J-1/4-CP
#2	R434	06S70072F39	RES,CP .271-J-1/4-CP
#1	R435	06S70072F37	RES,CP .221-J-1/4-CP
\$1	R435	06S70072F37	RES,CP .221-J-1/4-CP
%1	R435	06S70072F39	RES,CP .271-J-1/4-CP
&1	R435	06S70072F37	RES,CP .221-J-1/4-CP
#2	R435	06S70072F37	RES,CP .221-J-1/4-CP
#1	R436	06S70072F37	RES,CP .221-J-1/4-CP
\$1	R436	06S70072F43	RES,CP .391-J-1/4-CP
%1	R436	06S70072F43	RES,CP .391-J-1/4-CP
&1	R436	06S70072F37	RES,CP .221-J-1/4-CP
#2	R436	06S70072F37	RES,CP .221-J-1/4-CP
#1	R437	06S70072F39	RES,CP .271-J-1/4-CP
\$1	R437	06S70072F37	RES,CP .221-J-1/4-CP
%1	R437	06S70072F37	RES,CP .221-J-1/4-CP
&1	R437	06S70072F39	RES,CP .271-J-1/4-CP
#2	R437	06S70072F37	RES,CP .221-J-1/4-CP
	R438	06S70072F39	RES,CP .271-J-1/4-CP
#1	R439	06S70072F33	RES,CP .151-J-1/4-CP
\$1	R439	06S70072F37	RES,CP .221-J-1/4-CP
%1	R439	06S70072F37	RES,CP .221-J-1/4-CP
&1	R439	06S70072F33	RES,CP .151-J-1/4-CP
#2	R439	06S70072F37	RES,CP .221-J-1/4-CP
#1	R440	06S70072F33	RES,CP .151-J-1/4-CP
\$1	R440	06S70072F43	RES,CP .391-J-1/4-CP
%1	R440	06S70072F43	RES,CP .391-J-1/4-CP
&1	R440	06S70072F33	RES,CP .151-J-1/4-CP
#2	R440	06S70072F37	RES,CP .221-J-1/4-CP
#1	R441	06S70072F09	RES,CP .15R-J-1/4-CP
\$1	R441	06S70072F09	RES,CP .15R-J-1/4-CP
&1	R441	06S70072F09	RES,CP .15R-J-1/4-CP
#2	R441	06S70072F09	RES,CP .15R-J-1/4-CP
#1	R442	06S70072F09	RES,CP .15R-J-1/4-CP
\$1	R442	06S70072F09	RES,CP .15R-J-1/4-CP
&1	R442	06S70072F09	RES,CP .15R-J-1/4-CP
#2	R442	06S70072F09	RES,CP .15R-J-1/4-CP
\$1	R443	06S70072F10	RES,CP .16R-J-1/4-CP
#2	R443	06S70072F18	RES,CP .36R-J-1/4-CP
%1	R444	06S70072F23	RES,CP .56R-J-1/4-CP
%1	R445	06S70072F31	RES,CP .121-J-1/4-CP
%1	R446	06S70072F23	RES,CP .56R-J-1/4-CP
%1	R447	06S70072F31	RES,CP .121-J-1/4-CP
	R449	06S64995F77	RES,RK 103J 1/8 -CP
	R450	06S64995F77	RES,RK 103J 1/8 -CP
	R451	06S64995F77	RES,RK 103J 1/8 -CP
	R452	06S64995F53	RES,RK 102J 1/8 -CP
	R453	06S64995F77	RES,RK 103J 1/8 -CP
	R457	06S70072F49	RES,CP .681-J-1/4-CP
#1	R458	06S70072F39	RES,CP .271-J-1/4-CP
\$1	R458	06S70072F37	RES,CP .221-J-1/4-CP
%1	R458	06S70072F39	RES,CP .271-J-1/4-CP
&1	R458	06S70072F39	RES,CP .271-J-1/4-CP
#2	R458	06S70072F37	RES,CP .221-J-1/4-CP
\$1	R459	06S70072F17	RES,CP .33R-J-1/4-CP
#2	R459	06S70072F17	RES,CP .33R-J-1/4-CP

**CDM-9823R/CDM-9823RR/CDE-9822RB/
CDE-9821R/CDE-9823RM**

\$1	R460	06S70072F17	RES,CP .33R-J-1/4-CP
#2	R460	06S70072F17	RES,CP .33R-J-1/4-CP
%1	R462	06S45675W43	RES,RK JUMPER1/10-CP
&1	R462	06S45675W43	RES,RK JUMPER1/10-CP
#2	R462	06S45675W43	RES,RK JUMPER1/10-CP
	SW401	40T65353Y01	SW,TACT SKRSPACE010E2 (EJECT)
	SW402	40T65353Y01	SW,TACT SKRSPACE010E2 (4/RPT)
	SW403	40T65353Y01	SW,TACT SKRSPACE010E2 (3/PTY)
	SW404	40T65353Y01	SW,TACT SKRSPACE010E2 (MUTE)
	SW405	40T65353Y01	SW,TACT SKRSPACE010E2 (2/NEWS)
	SW406	40T65353Y01	SW,TACT SKRSPACE010E2 (6/SCAN)
	SW407	40T65353Y01	SW,TACT SKRSPACE010E2 (1/AF)
	SW408	40T65353Y01	SW,TACT SKRSPACE010E2 (5/M.I.X.)
	SW409	40T65353Y01	SW,TACT SKRSPACE010E2 (CENTER.f)
	SW410	40T65353Y01	SW,TACT SKRSPACE010E2 (T.INFO)
	SW411	40T65353Y01	SW,TACT SKRSPACE010E2 (MODE/LOUD)
	SW412	40T65353Y01	SW,TACT SKRSPACE010E2 (VOL UP)
	SW413	40T65353Y01	SW,TACT SKRSPACE010E2 (BWD/DN)
	SW414	40T65353Y01	SW,TACT SKRSPACE010E2 (VOL DN)
	SW415	40T65353Y01	SW,TACT SKRSPACE010E2 (BAND)
	SW416	40T65353Y01	SW,TACT SKRSPACE010E2 (F/SETUP)
	SW417	40T65353Y01	SW,TACT SKRSPACE010E2 (PLAY/PAUSE/TUNE/A.ME)
	SW418	40T65353Y01	SW,TACT SKRSPACE010E2 (SOURCE/POWER)
	SW419	40T65353Y01	SW,TACT SKRSPACE010E2 (FWD/UP)
	SW601	40T16096W03	SW ,TACT SKHHLW (RESET)
	TH601	48T25250Y01	TMT,ERTJ1VV104J -CP
	ZD401	48T62934F26	DIO,ZEN.RD6.2MB3 -CP
%1	ZD402	48T15541Y23	DIO,ZEN MAZS180 -CP
%1	ZD403	48T15541Y23	DIO,ZEN MAZS180 -CP
=====Switch P.W.Board			
	CH103	01T55281Y01	ASSY,WIRE JOINT 7P
=====Miscellaneous			
	ANT001	01T03151K02	ASSY,ANTCABLE ISO03R
	CB601	09T65330Y15	BTB,TMD-V15X-A1 -DB
	CB801	09T35343Y16	WTB,IMSA9451B-16 -DB

**CDM-9823R/CDM-9823RR/CDE-9822RB/
CDE-9821R/CDE-9823RM**

	CH401	09T15298Y15	BTB,TMD-V15P-A1 -B
#1	DIN501	09T55493W02	DIN,SKT 8P CMS-R -DT
\$1	DIN501	09T55493W02	DIN,SKT 8P CMS-R -DT
	JK001	09T03156K01	JAC,CK-3.5-14 -DB
#1	JK201	01T02234K03	ASSY,CONN NLT1661 (F/(R/SW))
\$1	JK201	01T02234K03	ASSY,CONN NLT1661 (F/(R/SW))
%1	JK201	01T02234K04	ASSY,CONN NLT1660 (R/SW)
&1	JK201	01T02234K04	ASSY,CONN NLT1660 (R/SW)
#2	JK201	01T02234K04	ASSY,CONN NLT1660 (R/SW)
#1	LCD401	65T65153Y05	LCD,WTD-21544ABHU
\$1	LCD401	65T65153Y06	LCD,WTD-21654AAHU
%1	LCD401	65T04146K02	LCD,PNA4342FH-39N
&1	LCD401	65T04146K01	LCD,PNA4342FH-49CN
#2	LCD401	65T04146K01	LCD,PNA4342FH-49CN
=====DP23S2BO			
	HD101	81B50360Y01	PICKUP,EP21A67L
	M101	01V56100Y14	ASSY,MOTOR WORM 2BO (3.5V-80mA)
	M102	01V56100Y12	ASSY,MOTOR SLED 2BO (3.5V-80mA)
	M103	01V56100Y11	ASSY,MTR SPINDOL 2BO (3V-90mA)
	SW1	40T15494Y01	SW,DETCT SPVG23 -E6 (12cm DISC DETECT (EJECT POSITION/RELOAD))
	SW2	40T15494Y02	SW,DETCT SPVG13 -E6 (8/12cm DISC DETCT (INSERT/PULL OUT))
	SW3	40T15494Y07	SW,DETCT SPVG21 -E6 (8cm DISC DETECT (EJECT POSITION/RELOAD))
	SW4	40T15494Y01	SW,DETCT SPVG23 -E6 (DISC CHUCKING END DETECT)
	SW105	40T71025F03	SW,DETCT SPPB120 (LIMIT)

**CDM-9823R/CDM-9823RR/CDE-9822RB/
CDE-9821R/CDE-9823RM**

Cabinet Assembly Parts List

Notes : * #1 : For CDM-9823R Model Only, \$1 : For CDM-9823RR Model Only,
 %1 : For CDE-9822RB Model Only, &1 : For CDE-9821R Model Only,
 #2 : For CDE-9821RM Model Only, Others : Common.
 * The part that has not PART NUMBER will not be supplied.

#1	1	01V73800Y95	ASSY,NOSE UNIT 23RN
\$1	1	01V73900Y28	ASSY,NOSE UNIT 23RR
%1	1	01V73900Y52	ASSY,NOSE UNIT 22RN
&1	1	01V73900Y36	ASSY,NOSE UNIT 21RN
#2	1	01V73900Y44	ASSY,NOSE UNIT 21RM
	2	-----	COVER, TOP
	3	-----	CHAS, BASE
	4	14B02859K01	INSULATOR, MAIN
	5	03S60824Y09	SCR, WEV 2.6X10 ZN A
	6	13C02811K01	NOSE, BASE ASSY
	7	03S60822Y12	SCR, S-T 2.6X6 ZN A
	8	33C01797K04	FACE, PLATE
	9	03S60825Y04	SCR, B-T 3X8 ZN A
	10	-----	HEAT, SINK(L)
	11	03S60822Y22	SCR, S-T 2.6X14 ZN A
	12	07D00749K01	BKT, SIDE L
	13	07D00749K02	BKT, SIDE R
	14	03T25225Y01	SCR, GND
	16	75S40755Y71	CUS, RUB 6X6X4
	18	77T65185Y01	TFTC7E112A(TU001)
	19	09T84840F01	LUG, STYLE 18MM
	20	-----	BKT, CHAS REAR(L)
	21	81D50701Y01	DP23S2B0, CD MECH
	23	03S71677F56	SCR, B-TITE M1.7X12
#1	24	13D02847K08	NOSE, PIECE ASSY(L)
\$1	24	13D02846K05	NOSE, PIECE ASSY(L)
%1	24	13D02846K06	NOSE, PIECE ASSY(L)
&1	24	13D02847K10	NOSE, PIECE ASSY(L)
#2	24	13D02846K07	NOSE, PIECE ASSY(L)
	25	13D02810K01	NOSE, BOTTOM
	26	15B01768K01	COVER, LCD
#1	27	26A01773K01	REFLECTOR, SHEET
\$1	27	26A01773K01	REFLECTOR, SHEET
%1	27	26A41376Y01	REFLECTOR, SHEET
&1	27	26A01773K01	REFLECTOR, SHEET
#2	27	26A01773K01	REFLECTOR, SHEET
	28	75T03213K02	RUBBER, ELECTRIC
#1	29	15D01772K01	CASE, LCD ASSY
\$1	29	15D01772K01	CASE, LCD ASSY
%1	29	15D01770K01	CASE, LCD ASSY
&1	29	15D01772K01	CASE, LCD ASSY
#2	29	15D01772K01	CASE, LCD ASSY
	30	03S60822Y10	SCR, S-T 2.6X5 ZN A
%1	32	26A41376Y02	REFLECTOR, SHEET(A)
&1	32	26A41975Y02	REFLECTOR, SHEET(A)
#2	32	26A41975Y02	REFLECTOR, SHEET(A)

**CDM-9823R/CDM-9823RR/CDE-9822RB/
CDE-9821R/CDE-9823RM**

CD Deck Mechanism Assembly Parts List

Note : The part that has not PART NUMBER will not be supplied.

1	01V43800Y84	ASSY,ARM GUIDE 280
2	-----	CHASSIS,TOP
3	45B11564Y02	LEVER,LINK-TOP
4	45B11595Y02	LEVER DISC(R)
5	45B11596Y02	LEVER,DISC(L)
6	41B11613Y16	SPRING,PULL
7	15D50248Y02	GUIDE, TOP-DPS2
8	75A21286Y04	CUSHION,CLAMPER DPS2
9	07C50608Y01	BKT,MOTOR LOAD-P
10	03S40014G07	SCR,MCH M2X4
11	44B11578Y02	GEAR,(A)
12	44B11579Y02	GEAR,(B)
13	44B11580Y02	GEAR,(C)
19	27D11602Y04	CHASSIS,PICKUP
20	47A11575Y01	SHAFT,PICK
21	01V28100Y59	ASSY,SHAFT.SCREW
22	44A70590W03	GEAR,MIDDLE
23	03S72235F96	SCR,MCH M1.7X3.5(SW)
24	07B30337Y02	BKT,SPRING NUT
25	41A11606Y02	SPRING NUT
26	03S94385F18	SCR,NYLOK M2X3.5
27	84T01803K01	PANEL,FPC CONT
28	41B11566Y02	SPRING,SHAFT
29	03S70494F13	SCR,P-TITE M2X6 BLK
30	-----	ASSY,RIV.ARM CLAMP
31	-----	LEVER,LOCK
32	07A11565Y02	PLATE,CLAMP
33	03S94385F01	SCR,NYLOK M1.7X2.3
34	43A41812Y02	TABLE,CLAMPER2
36	-----	SLIDER DISC
37	45A11599Y02	LEVER,ACTUATOR
38	41B11613Y03	SPRING,PULL
39	41B11613Y05	SPRING,LEV-ACT
40	41A11609Y01	SPRING,LEVER
41	41B40574Y02	SPRING,PLATE-S
42	41B11613Y15	SPRING,PULL
43	41A11040Y02	SPRING,SLED-HOE
44	03S70494F52	SCR,P-TITE M1.4X4.5
45	43A21240Y01	SHEET,FPC PICK
46	-----	ASSY,RIV CHAS BASE
47	45B40510Y02	SLIDER,LOAD
48	44B40527Y02	RACK
49	45A11601Y02	LEVER,TRIGER
50	44B11581Y02	GEAR,(D)
51	45B11594Y02	SLIDER,LOCK(L)
52	45A11592Y02	ARM,LOCK(L2)
53	03A11574Y01	SCREW,LOCK
54	45B11591Y02	ARM,LOCK(L1)
55	07A50606Y01	BKT,MOTOR WIRE-P
56	45B11593Y02	SLIDER,LOCK(R)
57	45B11607Y02	ARM,LOCK(R)
58	45A11597Y02	LEVER,SW

**CDM-9823R/CDM-9823RR/CDE-9822RB/
CDE-9821R/CDE-9823RM**

59	41B11613Y04	SPRING,TRIGER
60	75C30466Y14	DAMPER,DPS2
61	41B11613Y06	SPRING,PULL
62	41B11613Y07	SPRING,PULL
63	41B11613Y08	SPRING,PULL
64	41A40518Y01	SPRING,ROL
65	41A31894Y02	SPRING,SLIDER
66	-----	BKT,SP-TOP
67	03A21791Y01	SCREW,M2X3.5 S-TITE
68	07B20905Y02	BKT,FPC CONT
72	41A21613Y02	SPRING,SPINDLE
75	43A31443Y01	ROLLER,ARM DISC (C)
77	75C30466Y15	DAMPER,DPS2
78	41B11613Y14	SPLING,PULL
79	04B41345P52	WASH,1.6X3.5X0.25
81	75A21286Y02	CUSHION,CLAMPER BACK
82	44B40523Y02	GEAR,BASE
83	04A40528Y01	WASHER,FELT
84	44A40524Y02	GEAR,CLUTCH
85	41A40529Y01	SPRING,CLUTCH
86	44A40525Y02	GEAR,PINION
87	15A40526Y02	HOLDER,CLUTCH
88	43A41446Y02	SLEEVE,CLUTCH
89	04B41345P25	WASH,L. 3.1X6X0.35